

2022 /
2023

EN



Elektrosvit

SINCE 1906



Elektrosvit

SINCE 1906

CZECH PRODUCER OF ELECTRICAL LIGHT FITTINGS
WITH MORE THAN A CENTURY OF TRADITION

WWW.ELEKTROSVIT.CZ

Dear business partners, dear friends,

we would like to introduce you to our company ELEKTROSVIT Svatobořice, a.s., which has been on the market **for more than 115 years**. The production plant is located in the village of Svatobořice-Mistřín, about 50 km from Brno in the centre of South Moravia, which is famous for its love of wine and folklore.



Our company focuses on the production of light fittings, **our specialization is explosion-proof light fittings for hazardous areas (Ex)**, such as chemical plants, compressor stations, oil and gas extraction and processing, nuclear, thermal and hydroelectric power plants, paint shops, paper mills, gas mines, etc. In addition to non-explosive luminaires, we produce **industrial light fittings designed for demanding operations with a high degree of stress**, as well as floodlights and public lighting luminaires.

In this edition of the catalogue we introduce you to our new products, the extension of existing product lines and the creation of a new design line of retro light fittings.

All light fittings are issued with a declaration of conformity according to the current legislation. At the same time, the light fittings are manufactured in compliance with European standards EN. The certification of explosion-proof light fittings is in accordance with the requirements of the international standard **ATEX 2014/34/EU**. The company is involved in the system of EKO-KOM, which ensures the association of the fulfillment of the obligations of the take-back and recovery of packaging waste and EKOLAMP, which ensures the take-back and recycling of end-of-life light sources, light fittings and other electrical equipment. Our company holds a certificate of quality management according to **EN ISO 9001:2016**.

Current business activities are mainly oriented to the Czech market. Export activities are directed to the Slovak market, Central, Eastern and South-Eastern Europe, the EU, the Middle East and Central America. The company presents itself at national and international trade fairs and at regular professional seminars focused on lighting technology. We provide our customers with designs for interior and exterior lighting spaces and lighting calculations in the **WILS, DIALUX** program.

Since we would like to share our valuable experience in the production of lighting technology with other manufacturers of this or similar production, and on the contrary, possibly establish a beneficial cooperation, we invite all interested parties to contact us, either in person or in writing. All additional information about our company and the range of products we offer can be found on our company website: www.elektrosvit.cz

We thank all our customers for their cooperation so far, new customers for their interest and we look forward to further cooperation.

Mgr. Martin Šutka
Chairman of the Board

CONTENT



ORION LED	6
Zone 1/22	II 2G Ex db eb op is IIC T5-T6 Gb
Zone 2/22	II 2D Ex tb op is IIIC Tmax. of surface °C Db



SIRIUS LED	7
Zone 1/22	II 2G Ex db eb op is IIC T4 Gb
Zone 2/22	II 2D Ex tb op is IIIC T90°C Db of 591 44 01 (K)
	II 2G Ex db eb op is IIC T5 Gb
	II 2D Ex tb op is IIIC T81°C Db of 591 44 02 (K)
	II 2G Ex db eb op is IIC T5 Gb
	II 2D Ex tb op is IIIC T87°C Db of 591 44 03 (K)



ERIS LED	8
Zone 2/22	II 3G Ex nR IIC T6 Gc
	II 3D Ex tc IIIC Tmax. of surface °C Dc



BILUX LED	9
Zone 2/22	II 3G Ex nR IIC T6 Gc
	II 3D Ex tc IIIC Tmax. of surface °C Dc



TRILUX LED	10
Zone 2/22	II 3G Ex nR IIC T6 Gc
	II 3D Ex tc IIIC Tmax. of surface °C Dc



MULTISAFE LED	11
Zone 2/22	II 3G Ex nR IIC T6 Gc
	II 3D Ex tc IIIC Tmax. of surface °C Dc

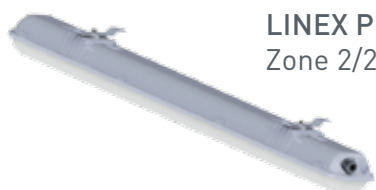

LINEX PLA LED	12
Zone 2/22	II 3G Ex ec IIC Tx Gc
	II 3D Ex tc IIIC Tmax. of surface °C Db



MINIMINEX LED	13
	I M2 Ex db op is I Mb



MINEX I	14
Zone 1/21	I M2 Ex d I Mb
Zone 2/22	II 2G Ex d IIB T4-T6 Gb
	II 2D Ex tb IIIC Tmax. of surface °C Db

SPARE PARTS	15
--------------------	-----------



EXPLOSION-PROOF LIGHT FITTINGS

ORION LED

Zone 1/21
Zone 2/22

II 2G Ex db eb op is IIC T5-T6 Gb
II 2D Ex tb op is IIIC Tmax. of surface °C Db

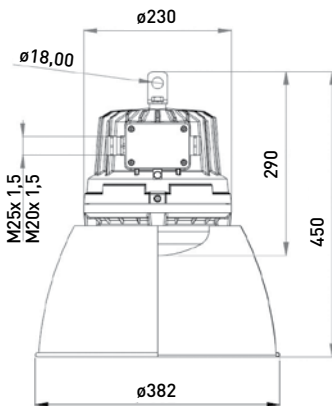

USE

Explosion-proof light fitting for the illumination of indoor and outdoor industrial spaces with a danger of gas, vapour, and dust explosion.

TECHNICAL DESCRIPTION

The body and flange of the light fitting are AlSi alloy castings finished with RAL 1005 powder paint. The optical cover is made of tempered glass. A steel suspension with an eye is fixed to the top part of the body. There are two cable outlets on the light fitting sides. There is a LED module built inside the light fitting and it is comprised of a board fitted with LEDs and a power supply. The light fitting is designed as a through light fitting, for three phase alternation (five-core cable). When the light fitting is used as a terminal light fitting, the free cable outlet is blinded with a plug. The max. cross-section of the connecting conductors is 4 mm². The light fitting is produced with plastic cable gland as standard, metal gland is available on request.

INSTALLATION

With a steel suspension with an eye $\varnothing 18$ mm

VERSIONS

Light fittings are provided with a self-resetting thermal fuse and a surge guard up to 10 kV. Standard light fittings are available with cable outlets M25x1.5, optionally with cable outlets M20x1.5

LIFETIME

100.000 hours, L90B10

DRIVER FUNCTIONS

eCLO, ITG, IVG+, Power-up fading

CONTROL

DALI-2

CE	LED	IP66		ATEX 2014/34/EU
3F	198-264V AC 176-280V DC	50 Hz 60 Hz	Ta	-40°C ÷ +50°C
Carton (mm/pcs) 300 x 250 x 250 / 1				

Type	Power input [W] / Luminous flux [lm]	Luminous efficiency [lm/W]	Temperature class / T max. of surface [°C]	Angle of beam [°]	Colour temperature [K]	CRI	Weight [kg]
591 39 04 (K)	50 / 7165	143	T5 / 90	120	4000	>80	10
591 39 05 (K)	30 / 4365	146	T6 / 80	120	4000	>80	10

*By adding letter „K“ behind type designation, light fittings will be provided with protective steel baskets (591 39 04K)

TO ORDER



Shade
254.5021/01



Protective basket
2-99.7461



Holder for mounting
on the ceiling
4-99.7995



Holder for mounting
on the wall
338.2735



Screw plug
V-Ex M25x1,5
M20x1,5



Blinding plug
HSK-V-Ex M25x1,5
M20x1,5



Rotating holder
3-99.6289

Cable glands
see page 15

SIRIUS LED

Zone 1/22 II 2G Ex db eb op is IIC T4 Gb
 Zone 2/22 II 2D Ex tb op is IIIC T90°C Db for 591 44 01 (K)
 II 2G Ex db eb op is IIC T5 Gb
 II 2D Ex tb op is IIIC T81°C Db for 591 44 02 (K)
 II 2G Ex db eb op is IIC T5 Gb
 II 2D Ex tb op is IIIC T87°C Db for 591 44 03 (K)



USE Explosion-proof light fitting for the illumination of indoor and outdoor industrial spaces with a danger of gas, vapour, and dust explosion.

TECHNICAL DESCRIPTION The body and flange of the light fitting are AlSi alloy castings finished with RAL 1005 powder paint. The optical cover is made of tempered glass. A steel suspension with eyes is fixed to the top part of the body. There are two cable outlets on the sides of the light fitting. The steel base plate with electrical equipment and reflector is built inside the light fitting. The light fitting is designed as a through light fitting, for three phase alternation (five-core cable). When the light fitting is used as a terminal light fitting, the free cable outlet is blinded with a plug. The max. cross-section of the connecting conductors is 4 mm². The light fitting is produced with plastic cable gland as standard, metal gland is available on request.

INSTALLATION With steel suspensions with eyes $\varnothing 16$ mm

VERSIONS Standard light fittings are available with cable outlets M25x1.5, optionally with cable outlets M20x1.5

LIFETIME 100.000 hours, L90B10

DRIVER FUNCTIONS eCLO, ITG, IVG+, Power-up fading

CONTROL DALI-2

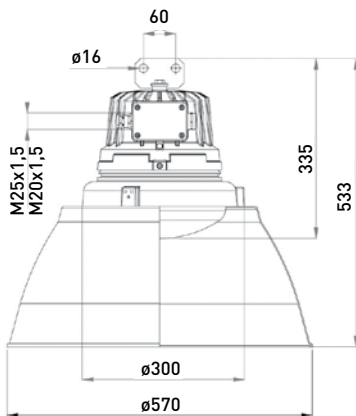

CE	LED	⊕	IP66	ATEX 2014/34/EU
198-264V AC 176-280V DC	50 Hz 60 Hz	Ta -40°C ÷ +50°C - 591 44 01 -40°C ÷ +55°C - 591 44 02 -40°C ÷ +60°C - 591 44 03		
Carton (mm/pcs) 350 x 350 x 340 / 1				

Type	Power input [W] / Luminous flux [lm]	Luminous efficiency [lm/W]	Temperature class / T max. of surface [°C]	Colour temperature [K]	CRI	Weight [kg]
591 44 01 (K)	100 / 15 025	150	T4 / 90	4000	>80	15
591 44 02 (K)	75 / 11 475	153	T5 / 81	4000	>80	15
591 44 03 (K)	65 / 9750	150	T5 / 87	4000	>80	14

*By adding letter „K“ behind type designation, light fittings will be provided with protective steel baskets (591 44 01 K)

TO ORDER



Shade
154.5041/2



Protective basket
2-99.6325



Holder for mounting
on the ceiling
4-99.7995



Holder for mounting
on the wall
338.2735



Blinding plug
HSK-V-Ex M25x1,5
M20x1,5



Rotating holder
3-99.6289

Cable glands
see page 15



ERIS LED

Zone 2/22 II 3G Ex nR IIC T6 Gc
II 3D Ex tc IIIC T80°C Dc

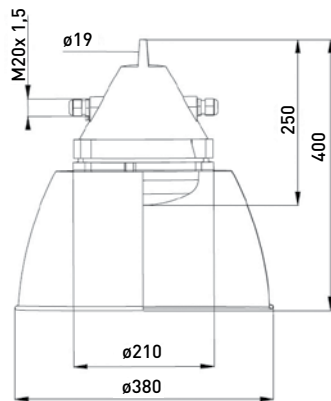

USE Explosion-proof light fitting for the illumination of indoor and outdoor industrial spaces with the danger of gas, vapour, and dust explosion.

TECHNICAL DESCRIPTION The body and flange of the light fitting are AlSi alloy castings finished with RAL 1005 powder paint. The optical cover is made of tempered glass. There are two cable outlets on the light fitting sides. There is a LED module built inside the light fitting and it is comprised of a board fitted with LEDs and a power supply. The light fitting is designed as a through light fitting, for a three-phase connection (five-core cable). When the light fitting is used as a terminal light fitting, the free cable outlet is blinded with a plug. The max. cross-section of the connecting conductors is 4 mm². The light fitting is produced with plastic cable gland as standard, metal gland is available on request.

INSTALLATION With a suspension eye ø19 mm, ceiling holder 4-99.8103, flexible suspension 2-99.5550

VERSIONS Light fittings are provided with a self-resetting thermal fuse and a surge guard up to 10 kV

LIFETIME 100.000 hours, L90B10

DRIVER FUNCTIONS eCLO, ITG, IVG+, Power-up fading

CONTROL DALI-2

CE	LED	IP66	ATEX 2014/34/EU
198-264V AC 176-280V DC	50 Hz 60 Hz	Ta -40°C ÷ +50°C	
Carton (mm/pcs) 240 x 240 x 260 / 1			

Type	Power input [W] /Luminous flux [lm]	Luminous efficiency [lm/W]	Temperature class /T max. of surface [°C]	Angle of beam [°]	Colour temperature [K]	CRI	Weight [kg]
591 15 01n	35 / 4786	137	T6/80	120	4000	>80	6
591 15 02n	25 / 3533	141	T6/80	120	4000	>80	6
591 15 03n	15 / 2179	143	T6/80	120	4000	>80	6

TO ORDER



Shade
254.5021/01



Flexible suspension
2-99.5550



Support holder
338.2783



Holder for mounting
on the ceiling
4-99.7995



Screw plug
V-MS-VMQ-Ex
M20x1,5



Blinding plug
HSK-V-Ex
M20x1,5

Cable glands
see page 15

BILUX LED

Zone 2/22 II 3G Ex nR IIC T6 Gc
II 3D Ex tc IIIC T80°C Dc



USE Explosion-proof light fitting for the illumination of indoor and outdoor industrial spaces with the danger of gas, vapour, and dust explosion.

TECHNICAL DESCRIPTION The body and flange of the light fitting are AlSi alloy castings finished with RAL 1005 powder paint. The optical cover is made of hardened glass. There are two cable outlets on the light fitting sides. There is a LED module built inside the light fitting and it is comprised of a board fitted with LEDs and a power supply. The light fitting is designed as a through light fitting, for three-phase connection (five-core cable). When the light fitting is used as a terminal light fitting, the free cable outlet is blinded with a plug. The max. cross-section of the connecting conductors is 4 mm². The light fitting is produced with plastic cable gland as standard, metal gland is available on request.

INSTALLATION On the ceiling, wall, or another solid substrate (structure) ensuring firm connection.

VERSIONS Light fittings are provided with a self-resetting thermal fuse and a surge guard up to 10 kV

LIFETIME 100.000 hours, L90B10

DRIVER FUNCTIONS eCLO, ITG, IVG+, Power-up fading

CONTROL DALI-2

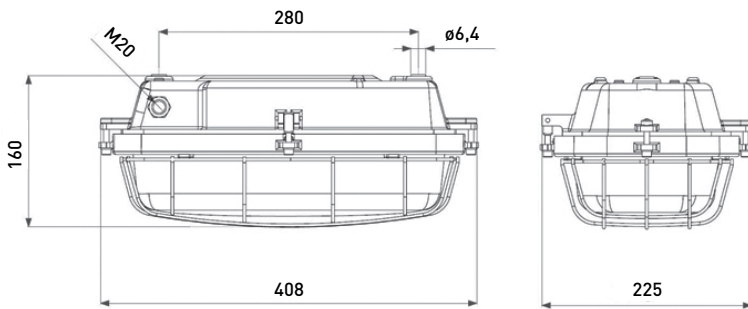

CE	LED	IP66	ATEX 2014/34/EU
198-264V AC 176-280V DC	50 Hz 60 Hz	Ta -40°C ÷ +50°C	
Carton (mm/pcs) 415 x 235 x 210 / 1			

Type	Power input [W] / Luminous flux [lm]	Luminous efficiency [lm/W]	Temperature class / T max. of surface [°C]	Angle of beam [°]	Colour temperature [K]	CRI	Weight [kg]
591 32 01 n	30 / 3572	119	T6/80	120	4000	>80	6
591 32 02 n	20 / 2419	120	T6/80	120	4000	>80	6
591 32 24 n (V DC)	12 / 1446	120	T6/80	120	4000	>80	6

TO ORDER



Protective sand-blasted glass
132.2551



Protective basket
1-99.5992/1



Wall/ceiling holder
338.2779



Screw plug
V-MS-VMQ-Ex
M20X1,5



Blinding plug
HSK-V-Ex
M20x1,5

Cable glands
see page 15



TRILUX LED

Zone 2/22

II 3G Ex nR IIC T6 Gc

II 3D Ex tc IIIC Tmax. of surface °C Dc

USE

Explosion-proof light fitting for the illumination of indoor and outdoor industrial spaces with a danger of gas, vapour, and dust explosion.

TECHNICAL DESCRIPTION

The light fitting body and flange are AlSi alloy castings finished with RAL 1005 powder paint. There are two cable outlets on the body sides. There is a LED module built inside the light fitting and it is comprised of a board fitted with LEDs and a power supply. The light fitting is designed as a through light fitting, for three-phase connection (five-core cable). When the light fitting is used as a terminal light fitting, the free cable outlet is blinded with a plug. The max. cross-section of the connecting conductors is 4 mm². The light fitting is produced with plastic cable gland as standard, metal gland is available on request.

INSTALLATION

On the ceiling, wall, or another solid substrate (structure) ensuring firm connection.

VERSIONS

The light fittings are provided with a self-resetting thermal fuse and a surge guard up to 10 kV

LIFETIME

100.000 hours, L90B10

DRIVER FUNCTIONS

eCLO, ITG, IVG+, Power-up fading

CONTROL

DALI-2

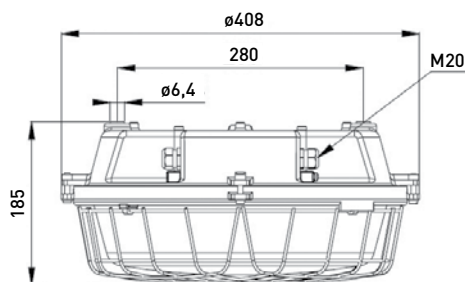

CE	LED	IP66	ATEX 2014/34/EU
198-264V AC 176-280V DC	50 Hz 60 Hz	Ta -40°C ÷ +50°C	
Carton (mm/pcs) 400 x 400 x 190 / 1			

Type	Power input [W] / Luminous flux [lm]	Luminous efficiency [lm/W]	Temperature class / T max. of surface [°C]	Angle of beam [°]	Colour temperature [K]	CRI	Weight [kg]
591 33 01n	50 / 6474	129	T6/80	120	4000	>80	8
591 33 02n	30 / 4039	129	T6/80	120	4000	>80	8
591 33 03n	20 / 2709	129	T6/80	120	4000	>80	8

TO ORDER



Protective glass
232.5070



Protective basket
1-99.5984/1



Wall/ceiling holder
338.2779



Screw plug
V-Ex M20x1,5



Blinding plug
HSK-V-Ex M20x1,5

Cable glands
see page 15

MULTISAFE LED

Zone 2/22

II 3G Ex nR IIC T6 Gc
II 3D Ex tc IIIC T80°C Dc



USE

Explosion-proof emergency light fitting for the permanent (M) and non-permanent (NM) illumination of indoor and outdoor industrial spaces with a danger of gas, vapour, and dust explosion.

TECHNICAL DESCRIPTION

The body and flange of the light fitting are ALSi alloy castings finished with RAL 1005 powder paint. The optical cover is made of hardened glass. There are two cable outlets on the sides of the light fitting. There is an emergency LED module with a battery built inside the light fitting. The light fitting is designed as a through light fitting, for two phase alternation (four-core cable). When the light fitting is used as a terminal light fitting, the free cable outlet is blinded with a plug. The max. cross-section of the connecting conductors is 4 mm². The light fitting is produced with plastic cable gland as standard, metal gland is available on request.

INSTALLATION

On the ceiling, wall, or another solid substrate (structure) ensuring firm connection.

VERSIONS

Light fittings are made in versions for permanent (M) and non-permanent (NM) emergency illumination, with autonomy of 3 hours.

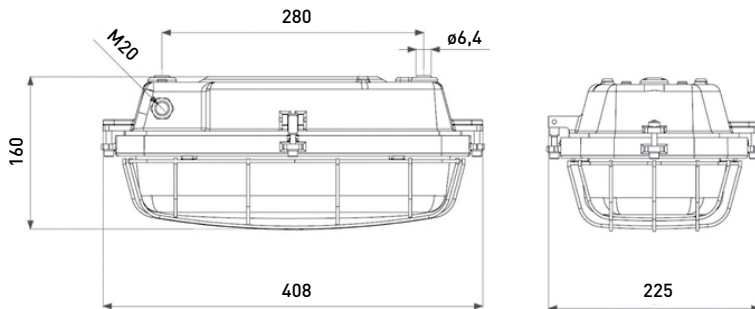

CE	230 V 50 Hz	IP66	ATEX 2014/34/EU
LED	EVG	EMERGENCY	Ta +5°C ÷ +40°C
Carton (mm/pcs) 415 x 235 x 170/1			

Type	Power input [W] /Charging power [W]	Luminous flux [lm] /Light flux during charging [lm]	Temperature class	Version	Autonomy [hrs]	Colour temperature [K]	Weight [kg]
591 32 01nEM	10 / 7	309 / 275	T6	M / NM	3	5700	5
591 32 02nEM	17 / 12	937 / 839	T6	M / NM	3	5700	5

TO ORDER



Protective glass
31108



Protective basket
1-99.5992/1



Wall/ceiling holder
338.2779



Screw plug
V-Ex M20x1,5



Blinding plug
HSK-V-Ex
M20x1,5

Cable glands
see page 15



LINEX PLA LED

Zone 2/22 II 3G Ex ec IIC Tx Gc
II 3D Ex tc IIIC Tmax. of surface °C Db

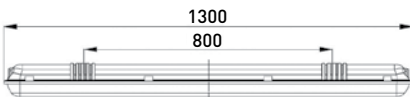
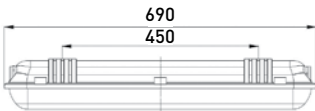
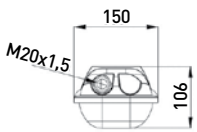

USE

Explosion-proof light fitting for the illumination of indoor and outdoor industrial spaces with a danger of gas, vapour, and dust explosion.

TECHNICAL DESCRIPTION

The light fitting body is made of glass-fibre-reinforced polyester (GRP). The diffuser is supplied as standard in UV stabilised polycarbonate (PC). The caps are made of stainless steel. The mounting brackets are made of sheet steel, powder-coated RAL 9003. The luminaire is equipped with a reflector made of sheet steel, powder-coated RAL 9003. The luminaire is manufactured as a 3-phase through luminaire. When the luminaire is used as an end luminaire, the free cable gland is blinded with an Ex-plug. The maximum cross-section of the connecting wires is 2,5mm².

INSTALLATION

On ceiling or wall using two brackets.

VERSIONS

Light fittings are supplied with M20x1.5 cable glands as standard. The luminaire can be manufactured with an emergency unit, designation 591 13 xx EM

LIFETIME

120.000 hours, L80B20

CE	LED	IP66	50 Hz 60 Hz	ATEX 2014/34/EU
EMERGENCY 	198 – 264V AC 176-280V DC	Ta -35°C ÷ +50°C		
Carton (mm/pcs)				
1600 x 190 x 129 / 1300 x 190 x 129 / 700 x 190 x 129				

Type	Power input [W] /Luminous flux [lm]	Efficiency [lm/W]	Temperature class	Colour temperature [K]	CRI	Weight [kg]
591 13 01	71 / 12642	177	T6	4000	>80	6,5
591 13 02	61 / 10272	166	T6	4000	>80	6,5
591 13 03	51 / 8620	170	T6	4000	>80	6,5
591 13 04	45 / 7944	177	T6	4000	>80	5,5
591 13 05	35 / 6197	179	T6	4000	>80	5,5
591 13 06	25 / 4435	166	T6	4000	>80	5,5
591 13 07	21 / 3572	169	T6	4000	>80	3,5
591 13 08	14 / 2414	168	T6	4000	>80	3,5

Parameters of the type with emergency unit			
Type	Operating time [h]	Power input [W]	Ambient temperature
591 13 xx EM	3	4,5	+5°C ÷ + 50°C

Type	L	L1	B	B1	H
591 13 01	1600	1000	190	160	129
591 13 02					
591 13 03					
591 13 04	1300	800	190	160	129
591 13 05					
591 13 06					
591 13 07					
591 13 08	700	450	190	160	129

TO ORDER



PC diffuser



Cable gland
Ex-e M20x,15



Nut
M20x1,5



Stainless steel cap
30543



Blinding plug
HSK-V-Ex M20x1,5

MINIMIMEX LED

I M2 Ex db op is I Mb

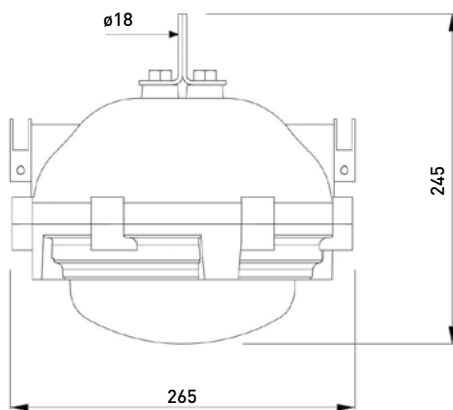

USE

Explosion-proof light fitting for the illumination of mine spaces with a danger of methane and coal dust explosion.

TECHNICAL DESCRIPTION

The body and flange of the light fitting are grey iron castings finished with RAL 1005 powder paint. The optical cover is made of tempered glass. A steel suspension with an eye is fixed to the top part of the body. There are two cable outlets on the light fitting sides. There is a LED module built inside the light fitting and it is comprised of a board fitted with LEDs and a power supply. The contact surface between the flange and the body of the light fitting makes up the cylindrical joint of the explosion-proof cap „d“. The light fitting is designed as a through light fitting, for three-phase connection (five-core cable). When the light fitting is used as a terminal light fitting, the free cable outlet is blinded with a plug. The max. cross-section of the connecting conductors is 4 mm².

INSTALLATION

With a steel suspension with an eye $\varnothing 18$ mm

VERSIONS

Light fittings are provided with a self-resetting thermal fuse and a surge guard up to 3 kV

LIFETIME

50.000 hours, L80B20

	230V 50Hz		ATEX 2014/34/EU
	3F	IP65	Ta -20°C ÷ +40°C
Carton (mm/pcs) 300 x 250 x 270 / 1			

Type	Power input [W] /Luminous flux [lm]	Luminous efficiency [lm/W]	Angle of beam [°]	Colour temperature [K]	CRI	Weight [kg]
591 40 01	25 / 2600	104	120	4000	>80	14



MINEX I

Zone 1/21
Zone 2/22

I M2 Ex d I Mb
II 2G Ex d IIB T4-T6 Gb
II 2D Ex tb IIIC Tmax. of surface °C Db



USE

Explosion-proof light fitting for the illumination of mine spaces with a danger of methane and coal dust explosion as well as industrial spaces with a danger of gas, vapour and dust explosion.

TECHNICAL DESCRIPTION

The body and flange of the light fitting are grey iron castings finished with RAL 1005 powder paint. The optical cover is made of tempered glass. A steel suspension with an eye is fixed to the top part of the body. There are two cable outlets on the light fitting sides. The contact surface between the flange and the body of the light fitting makes up the threaded joint of the explosion-proof cap „d“. The light fitting is designed as a through light fitting, the terminal board allows two phase alternation (four-core cable). When the light fitting is used as a terminal light fitting, the free cable outlet is blinded with a plug. The max. cross-section of the connecting conductors is 4 mm².

INSTALLATION

With a steel suspension with an eye ø18 mm

LIFETIME

50.000 hours, L80B20

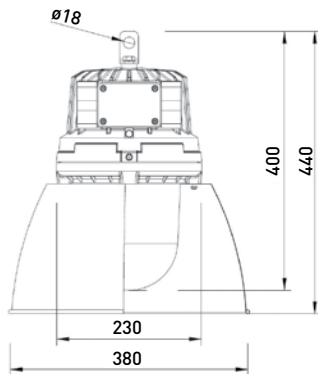

CE	230V 50Hz		IP65	ATEX 2014/34/EU
VVG	220V DC	E27	G24d-3	Ta -20°C ÷ +40°C
Carton (mm/pcs) 430 x 240 x 240 / 1				

Type	Recommended light source [W]	Temperature class	T max. of surface [°]	Voltage [V/Hz]	Weight [kg]
511 37 01	Halogen bulb Philips EcoClassic 140	T4	105	230/50	18
	Halogen bulb Philips EcoClassic 105	T5	91	230/50	
	Halogen bulb Philips EcoClassic 70	T6	79	230/50	
	Compact fluorescent tube Philips Master PL Electronic 23	T6	62	230/50	
	Bulb CLAS 200	T4	105	230/50	
	Bulb CLAS 150	T5	92	230/50	
	Bulb CLAS 60-100	T6	80	230/50	
	Compact fluorescent tube DULUX EL 23	T6	60	230/50	
	Blended lamp HWL 160	T5	90	230/50	
541 33 02	Bulb CLAS 100	T5	85	220 V DC	19
	High-pressure mercury discharge lamp HQL 125	T4	121	230/50	
	High-pressure sodium discharge lamp NAV-E 110/I	T4	100	230/50	

TO ORDER



Shade
254.5021/01



Protective basket
2-99.7461



Holder for mounting on the ceiling
4-99.7995



Holder for mounting on the wall
338.2735

SPARE PARTS

TO ORDER



Shade
154.5041/2



Shade
254.5021/01



Protective sand-blasted glass
132.2551



Protective glass clear
31108



Protective sand-blasted glass
232.5070



Protective basket
1-99.5992/1



Protective basket
1-99.5984/1



Protective basket
2-99.7461



Protective basket
2-99.7461



Protective basket
2-99.6325



PC diffuser



Rotating holder
3-99.6289



Support holder
338.2783



Wall/ceiling holder
338.2779



Holder for mounting on the ceiling
4-99.7995



Holder for mounting on the wall
338.2735



Screw plug
V-Ex
M25x1,5 / M20x1,5



Blinding plug
HSK-V-Ex
M25x1,5 / M20x1,5



Cable gland
Ex-e
M20x1,5 / M25x1,5



Cable gland
Ex-e
M20x1,5 / M25x1,5



Gland nut
GM-FS



Nut
M20x1,5 / M25x1,5



Stainless steel cap
30543



Flexible suspension
2-99.5550



Cable gland
HSK-M-Ex
M25x1,5 / M20x1,5



Cable gland
M20x1,5 / M25x1,5













Nut
M20x1,5 / M25x1,5



Screw plug
V-MS-VMQ-Ex
M25x1,5 / M20x1,5



CONTENT

	PEGAS LED	18
	PEGAS LED PRO	19
	JUNIOR LED	20
	JUNIOR LED PRO	21
	FARMER I LED	22
	FARMER I LED PRO	24
	FARMER II LED	26
	TAURUS LED	27
	TUB LED	28
	TUB LED PRO	29
	TURTLE LED	30
	TURTLE LED PRO	31
	MULTIFREEZE LED	32
	ŠACHO LED	33
	PRACHO PLA LED	34
	SPARE PARTS	35



INDUSTRIAL LIGHT FITTINGS

PEGAS LED



USE Light fitting for the illumination of heavy indoor and outdoor industrial spaces with a high level of mechanical stress.

TECHNICAL DESCRIPTION The light fitting body and flange are AlSi alloy castings finished with powder paint. The optical cover is made of tempered glass. A steel suspension with an eye is fixed to the top part of the body. There are two cable outlets on the light fitting sides. There is a LED module built inside the light fitting and it is comprised of a board fitted with LEDs and a power supply. The light fitting is designed as a through light fitting, for three-phase connection (five-core cable). When the light fitting is used as a terminal light fitting, the free cable outlet is blinded with a plug. The max. cross-section of the connecting conductors is 4 mm². The light fitting is produced with plastic cable gland as standard, metal gland is available on request.

INSTALLATION With a steel suspension with an eye $\varnothing 18$ mm

VERSIONS Light fittings are provided with a self-resetting thermal fuse and surge guard up to 3,75 kV. Standard light fittings are available with cable outlets M25x1.5, optionally with cable outlets M20x1.5

LIFETIME 50.000 hours, L80B20

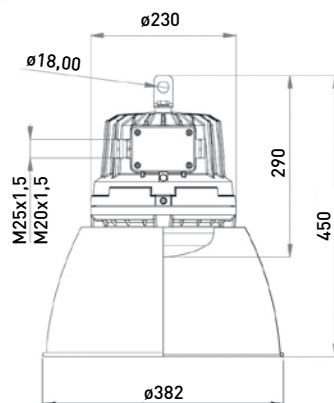

CE	⏚	LED	198 – 264V AC 176–280V DC
IP66	50 Hz 60 Hz	Ta -30°C ÷ +40°C	
Carton (mm/pcs) 300 x 250 x 270 / 1			

Type	Power input [W] / Luminous flux [lm]	Luminous efficiency [lm/W]	Angle of beam [°]	Colour temperature [K]	CRI	Weight [kg]
591 41 01 (K)	50 / 7000	130	120	4000	>80	10
591 41 02 (K)	30 / 4365	130	120	4000	>80	10

*By adding the letter „K” after type designation, light fittings will be provided with protective steel baskets (591 41 01 K).

TO ORDER



Shade
254.5021/01



Holder for mounting
on the ceiling
4-99.7995



Holder for mounting
on the wall
338.2735



Cable gland plastic
M20x1,5 / M25x1,5



Cable gland metal
M20x1,5 / M25x1,5



Blinding plug
M20x1,5 / M25x1,5

PEGAS LED PRO



USE

Light fitting for the illumination of heavy indoor and outdoor industrial spaces with a high level of mechanical stress.

TECHNICAL DESCRIPTION

The light fitting body and flange are AlSi alloy castings finished with powder paint. The optical cover is made of tempered glass. A steel suspension with an eye is fixed to the top part of the body. There are two cable outlets on the light fitting sides. There is a LED module built inside the light fitting and it is comprised of a board fitted with LEDs and a power supply. The light fitting is designed as a through light fitting, for three-phase connection (five-core cable). When the light fitting is used as a terminal light fitting, the free cable outlet is blinded with a plug. The max. cross-section of the connecting conductors is 4 mm². The light fitting is produced with plastic cable gland as standard, metal gland is available on request.

INSTALLATION With a steel suspension with an eye $\varnothing 18$ mm

VERSIONS Light fittings are provided with a self-resetting thermal fuse and surge guard up to 10 kV. Standard light fittings are available with cable outlets M25x1.5, optionally with cable outlets M20x1.5

LIFETIME 100.000 hours, L90B10

DRIVER FUNCTIONS eCLO, ITG, IVG+, Power-up fading

CONTROL DALI-2

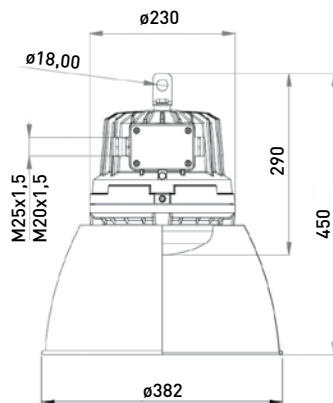

CE		198 - 264V AC 176-280V DC
IP66	50 Hz 60 Hz	Ta -40°C ÷ +50°C
Carton (mm/pcs) 300 x 250 x 270 / 1		

Type	Power input [W] / Luminous flux [lm]	Luminous efficiency [lm/W]	Angle of beam [°]	Colour temperature [K]	CRI	Weight [kg]
591 41 01 (K) PRO	50 / 7000	140	120	4000	>80	10
591 41 02 (K) PRO	30 / 4365	146	120	4000	>80	10

*By adding the letter „K” after type designation, light fittings will be provided with protective steel baskets (591 41 01 K PRO).

TO ORDER



Shade
254.5021/01



Holder for mounting
on the ceiling
4-99.7995



Holder for mounting
on the wall
338.2735



Cable gland plastic
M20x1,5 / M25x1,5



Cable gland metal
M20x1,5 / M25x1,5



Blinding plug
M20x1,5 / M25x1,5



JUNIOR LED



USE Light fitting for the illumination of heavy indoor and outdoor industrial spaces with a high level of mechanical stress.

TECHNICAL DESCRIPTION The light fitting body and flange are AlSi alloy castings finished with powder paint. The optical cover is made of tempered glass. There are two cable outlets on the light fitting sides. There is a LED module built inside the light fitting and it is comprised of a board fitted with LEDs and a power supply. The light fitting is designed as a through light fitting, for three-phase connection (five-core cable). When the light fitting is used as a terminal light fitting, the free cable outlet is blinded with a plug. The max. cross-section of the connecting conductors is 4 mm². The light fitting is produced with plastic cable gland as standard, metal gland is available on request.

INSTALLATION With a suspension eye $\varnothing 19$ mm, ceiling holder 4-99.7995, flexible suspension 2-99.5550

VERSIONS Light fittings are provided with a self-resetting thermal fuse and surge guard up to 3 kV

LIFETIME 50.000 hours, L80B20

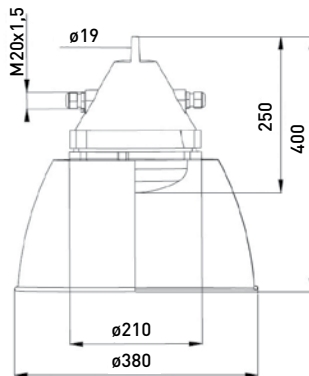

CE	⏚	LED	198 – 264V AC 176-280V DC
IP66	50 Hz 60 Hz	Ta -30°C ÷ +40°C	
Carton (mm/pcs) 240 x 240 x 260 / 1			

Type	Power input [W] / Luminous flux [lm]	Luminous efficiency [lm/W]	Angle of beam [°]	Colour temperature [K]	CRI	Weight [kg]
591 15 01 (K)	35 / 4694	137	120	4000	>80	6
591 15 02 (K)	25 / 3501	141	120	4000	>80	6
591 15 03 (K)	15 / 2196	143	120	4000	>80	6

*By adding the letter „K“ behind type designation, light fittings will be provided with protective steel basket (591 15 01 K).

TO ORDER



Shade
254.5021/01



Holder for mounting
on the ceiling
4-99.7995



Holder for mounting
on the wall
338.2735



Cable gland plastic
M20x1,5 / M25x1,5



Cable gland metal
M20x1,5 / M25x1,5



Blinding plug
M20x1,5 / M25x1,5

JUNIOR LED PRO



USE

Light fitting for the illumination of heavy indoor and outdoor industrial spaces with a high level of mechanical stress.

TECHNICAL DESCRIPTION

The light fitting body and flange are AlSi alloy castings finished with powder paint. The optical cover is made of tempered glass. There are two cable outlets on the light fitting sides. There is a LED module built inside the light fitting and it is comprised of a board fitted with LEDs and a power supply. The light fitting is designed as a through light fitting, for three-phase connection (five-core cable). When the light fitting is used as a terminal light fitting, the free cable outlet is blinded with a plug. The max. cross-section of the connecting conductors is 4 mm². The light fitting is produced with plastic cable gland as standard, metal gland is available on request.

INSTALLATION

With a suspension eye $\varnothing 19$ mm, ceiling holder 4-99.7995, flexible suspension 2-99.5550

VERSIONS

Light fittings are provided with a self-resetting thermal fuse and surge guard up to 10 kV

LIFETIME

100.000h, L90B10

DRIVER FUNCTIONS

eCLO, ITG, IVG+, Power-up fading

CONTROL

DALI-2

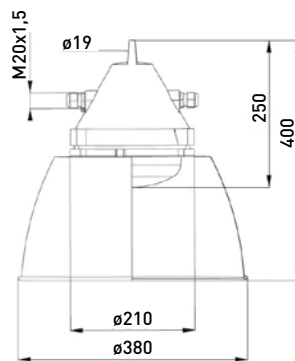

CE	LED	198 – 264V AC 176-280V DC
IP66	50 Hz 60 Hz	Ta -40°C ÷ +50°C
Carton (mm/pcs) 240 x 240 x 260 / 1		

Type	Power input [W] / Luminous flux [lm]	Luminous efficiency [lm/W]	Angle of beam [°]	Colour temperature [K]	CRI	Weight [kg]
591 15 01 (K) PRO	35 / 4786	137	120	4000	>80	6
591 15 02 (K) PRO	25 / 3533	141	120	4000	>80	6
591 15 03 (K) PRO	15 / 2179	143	120	4000	>80	6

*By adding the letter „K“ behind type designation, light fittings will be provided with protective steel basket (591 15 01 K PRO).

TO ORDER



Shade
254.5021/01



Holder for mounting
on the ceiling
4-99.7995



Holder for mounting
on the wall
338.2735



Cable gland plastic
M20x1,5 / M25x1,5



Cable gland metal
M20x1,5 / M25x1,5



Blinding plug
M20x1,5 / M25x1,5



FARMER I LED



591 36 01K

591 36 02K

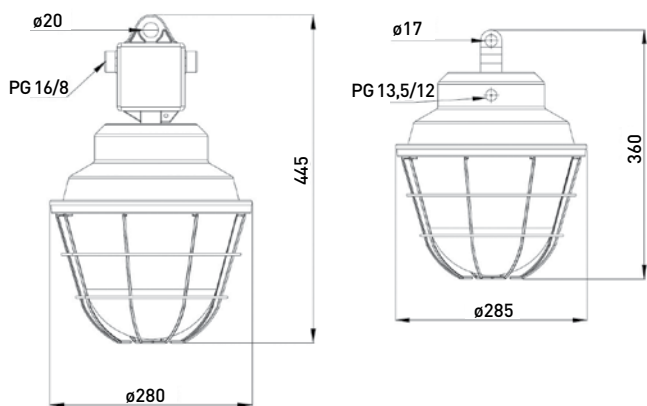

USE

Light fitting for the illumination of indoor and outdoor industrial spaces.

TECHNICAL DESCRIPTION

The body is made of steel sheet and finished with powder paint. The inorganic glass cover with seal and protective basket are fixed to the body with four metal caps. There is a LED module built inside the light fitting and it is comprised of a board fitted with LEDs and a power supply. According to the individual types, the light fitting includes: an AlSi terminal box, a steel pipe, or a galvanized steel sheet boom. The light fitting is made as a through light fitting and is provided with two cable outlets. The max. cross-section of the connecting conductors is 4 mm². The light fitting is produced with plastic cable gland as standard, metal gland is available on request.

INSTALLATION On the ceiling, wall.

VERSIONS

Optional version of light fittings with reinforced corrosion protection – version „pz“, version with a protective steel basket – version „K“, version with a protective polycarbonate basket and stainless-steel caps – version „p“. Light fittings are provided with a self-resetting thermal fuse and surge guard up to 3 kV.

LIFETIME

50.000 hours, L80B20

CE	LED	198-264V AC 176-276 V DC
IP66 591 36 01 591 36 02	50 Hz 60 Hz	Ta -30°C ÷ +40°C
Carton (mm/pcs) 1000 x 280 x 280 / 2 650 x 280 x 280 / 2 650 x 320 x 280 / 2		

Type	Part of light fitting	Power input [W] / Luminous flux [lm]	Luminous efficiency [lm/W]	Angle of beam [°]	Colour temperature [K]	CRI	Weight [kg]
591 36 01 (K)	Terminal box	30 / 4300	144	120	4000	>80	4,8
591 36 02 (K)	Holder						

* / ** / ***

TO ORDER



Glass cover
232.5068/1



Protective steel basket
1-99.6231



Protective polycarbonate basket 182.2540
PMMA Protective basket 182.5005



Stainless steel cap
4-99.6180



Metal cap
4-99.8470



Blinding plug
M20x1,5

FARMER I LED



592 36 03K



593 36 04K

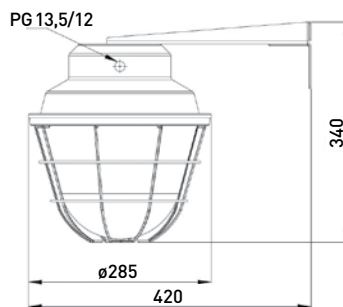
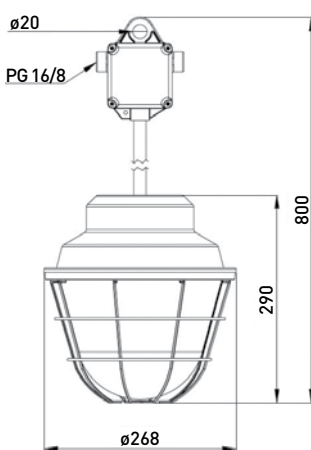

USE

Light fitting for the illumination of indoor and outdoor industrial spaces.

TECHNICAL DESCRIPTION

The body is made of steel sheet and finished with powder paint. The inorganic glass cover with seal and protective basket are fixed to the body with four metal caps. There is a LED module built inside the light fitting and it is comprised of a board fitted with LEDs and a power supply. According to the individual types, the light fitting includes: an AlSi terminal box, a steel pipe, or a galvanized steel sheet boom. The light fitting is made as a through light fitting and is provided with two cable outlets. The max. cross-section of the connecting conductors is 4 mm². The light fitting is produced with plastic cable gland as standard, metal gland is available on request.

INSTALLATION

On the ceiling, wall.

VERSIONS

Optional version of light fittings with reinforced corrosion protection – version „pz“, version with a protective steel basket – version „K“, version with a protective polycarbonate basket and stainless-steel caps – version „p“. Light fittings are provided with a self-resetting thermal fuse and surge guard up to 3 kV.

LIFETIME

50.000 hours, L80B20

CE		198 – 264V AC 176-276V DC
50 Hz 60 Hz		Ta -30°C ÷ +40°C
Carton (mm/pcs)		1000 x 280 x 280 / 2 650 x 280 x 280 / 2 650 x 320 x 280 / 2

Type	Part of light fitting	Power input [W] /Luminous flux [lm]	Luminous efficiency [lm/W]	Angle of beam [°]	Colour temperature [K]	CRI	Weight [kg]
592 36 03 (K)	Pipe and terminal box	30 / 4300	144	120	4000	>80	4,8
593 36 04 (K)	Boom						

*By adding the letter „K“ after the type designation, the light fittings will be provided with protective baskets (591 36 01K).

**By adding the letter „p“ after the type designation, the light fittings will be made with protective polycarbonate baskets and stainless-steel caps – for harsh conditions (591 36 01p).

***By adding the letters „pz“ after the type designation, the light fittings will be made with reinforced corrosion protection – for extra harsh conditions (591 36 01Kpz).



FARMER I LED PRO



591 36 01K PRO



591 36 02K PRO

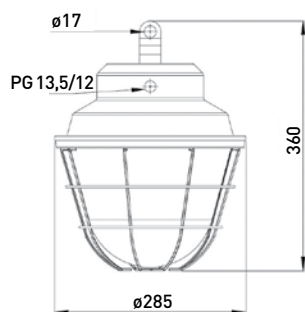
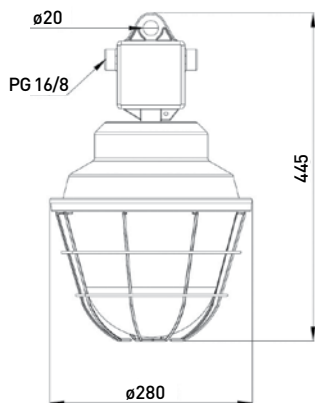

USE

Light fitting for the illumination of indoor and outdoor industrial spaces.

TECHNICAL DESCRIPTION

The body is made of steel sheet and finished with powder paint. The inorganic glass cover with seal and protective basket are fixed to the body with four metal caps. There is a LED module built inside the light fitting and it is comprised of a board fitted with LEDs and a power supply. According to the individual types, the light fitting includes: an ALSi terminal box, a steel pipe, or a galvanized steel sheet boom. The light fitting is made as a through light fitting and is provided with two cable outlets. The max. cross-section of the connecting conductors is 4 mm². The light fitting is produced with plastic cable gland as standard, metal gland is available on request.

INSTALLATION On the ceiling, wall.

VERSIONS

Optional version of light fittings with reinforced corrosion protection – version „pz“, version with a protective steel basket – version „K“, version with a protective polycarbonate basket and stainless-steel caps – version „p“. Light fittings are provided with a self-resetting thermal fuse and surge guard up to 10 kV.

LIFETIME

100.000 hours, L90B10

DRIVER FUNCTIONS

eCLO, ITG, IVG+, Power up fading

CONTROL

DALI-2

		IP54	198-264V AC 176-276 V DC
	IP66 591 36 02	Ta -40°C ÷ +50°C	
Carton (mm/pcs) 1000 x 280 x 280 / 2 650 x 280 x 280 / 2 650 x 320 x 280 / 2			

Type	Part of light fitting	Power input [W] / Luminous flux [lm]	Luminous efficiency [lm/W]	Angle of beam [°]	Colour temperature [K]	CRI	Weight [kg]
591 36 01 (K) PRO	Terminal box	30 / 4620	154	120	4000	>80	4,8
591 36 02 (K) PRO	Holder						

*/**/**

TO ORDER



Glass cover
232.5068/1



Protective steel basket
1-99.6231



Protective polycarbonate basket 182.2540
PMMA Protective basket 182.5005



Stainless steel cap
4-99.6180



Metal cap
4-99.8470



Blinding plug
M20x1,5

FARMER I LED PRO



592 36 03K PRO



593 36 04K PRO

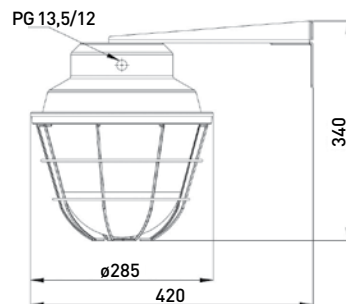
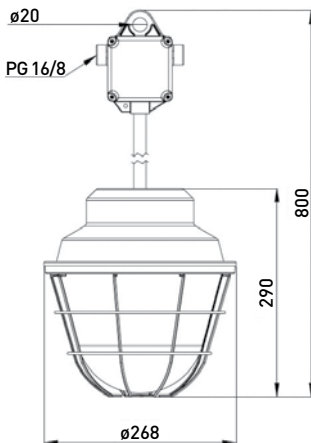

USE

Light fitting for the illumination of indoor and outdoor industrial spaces.

TECHNICAL DESCRIPTION

The body is made of steel sheet and finished with powder paint. The inorganic glass cover with seal and protective basket are fixed to the body with four metal caps. There is a LED module built inside the light fitting and it is comprised of a board fitted with LEDs and a power supply. According to the individual types, the light fitting includes: an ALSi terminal box, a steel pipe, or a galvanized steel sheet boom. The light fitting is made as a through light fitting and is provided with two cable outlets. The max. cross-section of the connecting conductors is 4 mm². The light fitting is produced with plastic cable gland as standard, metal gland is available on request.

INSTALLATION On the ceiling, wall.

VERSIONS Optional version of light fittings with reinforced corrosion protection – version „pz“, version with a protective steel basket – version „K“, version with a protective polycarbonate basket and stainless-steel caps – version „p“. Light fittings are provided with a self-resetting thermal fuse and surge guard up to 10 kV.

LIFETIME 100.000 hours, L90B10

DRIVER FUNCTIONS eCLO, ITG, IVG+, Power up fading

CONTROL DALI-2

CE	⏚	IP54	198-264V AC 176-276 V DC
LED	591 36 02	Ta -40°C ÷ +50°C	
Carton (mm/pcs)		1000 x 280 x 280 / 2	650 x 320 x 280 / 2

Type	Part of light fitting	Power input [W] /Luminous flux [lm]	Luminous efficiency [lm/W]	Angle of beam [°]	Colour temperature [K]	CRI	Weight [kg]
592 36 03 (K) PRO	Pipe and terminal box	30 / 4620	154	120	4000	>80	4,8
593 36 04 (K) PRO	Boom						

*By adding the letter „K“ after the type designation, the light fittings will be provided with protective baskets (591 36 01K PRO).

**By adding the letter „p“ after the type designation, the light fittings will be made with protective polycarbonate baskets and stainless-steel caps – for harsh conditions (591 36 01p PRO).

**By adding the letters „pz“ after the type designation, the light fittings will be made with reinforced corrosion protection – for extra harsh conditions (591 36 01Kpz PRO).



FARMER II LED



591 37 01K

592 37 03K

593 37 04K

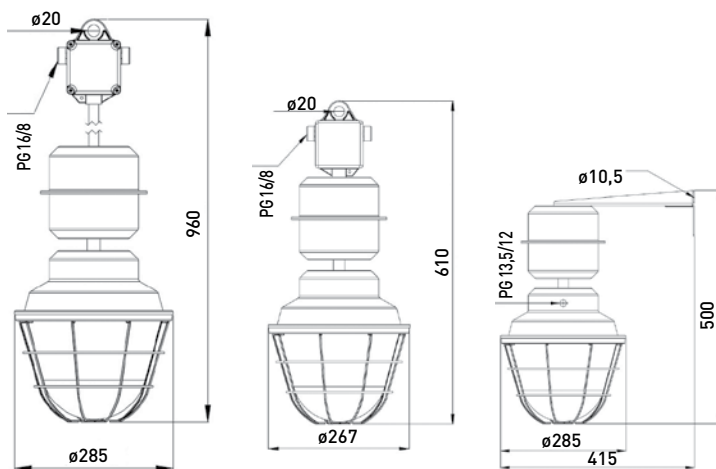

USE Light fitting for the illumination of indoor and outdoor industrial spaces.

TECHNICAL DESCRIPTION The body is made of steel sheet and finished with powder paint. The inorganic glass cover with a seal and protective basket is fixed to the body with four metal caps. There is a LED module built inside the light fitting and it is comprised of a board fitted with LEDs and a power supply. According to the individual types, the light fitting includes: an ALSi terminal box, a steel pipe, or a galvanized steel sheet boom. The light fitting is made as a through light fitting and is provided with two cable outlets. The max. cross-section of the connecting conductors is 4 mm². The light fitting is produced with plastic cable gland as standard, metal gland is available on request.

INSTALLATION On the ceiling, wall.

VERSIONS Optional version of light fittings with reinforced corrosion protection – version „pz“, version with a protective steel basket – version „K“, version with a protective polycarbonate basket and stainless-steel caps – version „p“. The light fittings are provided with a self-resetting thermal fuse and a surge guard up to 3 kV.

LIFETIME 50.000 hours, L80B20

CE		198-264V AC 176-276V DC
IP54		Ta -35°C ÷ +40°C
Carton (mm/pcs)		1000 x 280 x 280 / 2 650 x 280 x 280 / 1 590 x 490 x 260 / 2

Type	Part of light fitting	Power input [W] / Luminous flux [lm]	Luminous efficiency [lm/W]	Angle of beam [°]	Colour temperature [K]	CRI	Weight [kg]
591 37 01 (K)	Terminal box	45 / 6480	144	120	4000	>80	8
592 37 03 (K)	Pipe + terminal box						
593 37 04 (K)	Boom						

*/**/**

TO ORDER



Glass cover
232.5068/1



Protective steel basket
1-99.6231



Protective polycarbonate basket
182.2540



PMMA Protective basket
182.5005



Stainless steel cap
4-99.6180



Metal cap
4-99.8470

TAURUS LED

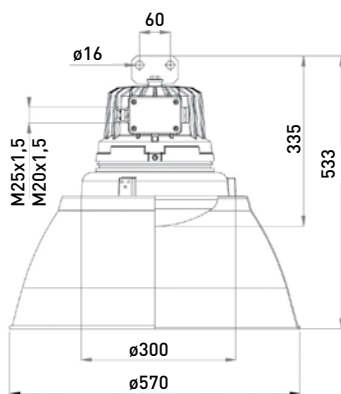

USE Light fitting for the illumination of heavy indoor and outdoor industrial spaces with a high level of mechanical stress.

TECHNICAL DESCRIPTION The body and flange of the light fitting are AlSi alloy castings finished with RAL 5012 powder paint. The optical cover is made of tempered glass. A steel suspension with eyes is fixed to the top part of the body. There are two cable outlets on the sides of the light fitting. The steel base plate with electrical equipment and reflector is built inside the light fitting. The light fitting is designed as a through light fitting, for two phase alternation (four-core cable). When the light fitting is used as a terminal light fitting, the free cable outlet is blinded with a plug. The max. cross-section of the connecting conductors is 4 mm². The light fitting is produced with plastic cable gland as standard, metal gland is available on request.

INSTALLATION With steel suspensions with eyes $\varnothing 16$ mm

VERSIONS Standard light fittings are available with cable outlets M25x1,5, optionally with cable outlets M20x1,5

LIFETIME 100.000 hours, L90B10

CONTROL DALI-2

			IP66	ATEX 2014/34/EU
50 Hz	198-264V AC	T_a -40°C ÷ +50°C - 591 46 01 -40°C ÷ +55°C - 591 46 02 -40°C ÷ +60°C - 591 46 03		
60 Hz	176-280V DC			
Carton (mm/pcs) 350 x 350 x 340 / 1				

Type	Power input [W] / Luminous flux [lm]	Luminous efficiency [lm/W]	Angle of beam [°]	Colour temperature [K]	CRI	Weight [kg]
591 46 01 (K)	100 / 15025	150	120	4000	>80	15
591 46 02 (K)	75 / 11475	153	120	4000	>80	15
591 46 03 (K)	65 / 9750	150	120	4000	>80	14

*By adding letter „K” behind type designation, light fittings will be provided with protective steel baskets (591 46 01 K)

TO ORDER



Shade
154.5041/2



Protective basket
2-99.6325



Holder for mounting on the ceiling
4-99.7995



Holder for mounting on the wall
338.2735



Cable gland plastic
M20x1,5 / M25x1,5



Cable gland metal
M20x1,5 / M25x1,5



TUB LED

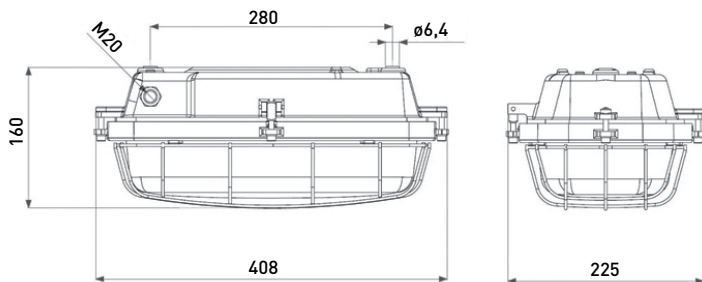

USE Light fitting for the illumination of indoor and outdoor industrial spaces.

TECHNICAL DESCRIPTION The light fitting body and flange are AlSi alloy castings finished with powder paint. There are two cable outlets on the sides of the light fitting. There is a LED module built inside the light fitting and it is comprised of a board fitted with LEDs and a power supply. The light fitting is designed as a through light fitting. When the light fitting is used as a terminal light fitting, the free cable outlet is blinded with a plug. The max. cross-section of the connecting conductors is 2.5 mm². The light fitting is produced with plastic cable glands as a standard, metal cable glands are available on request.

INSTALLATION On the ceiling, wall.

VERSIONS The light fittings are provided with a self-resetting thermal fuse and a surge guard up to 3 kV. Light fittings, type 591 34 01EM, are made in versions for permanent (M) and non-permanent (NM) emergency illumination, with autonomy of 3 hours. The luminaire type 591 34 24 is powered by a 9-60V DC power supply.

LIFETIME 50.000 hours, L80B20

Type	Power input [W] / Luminous flux [lm]	Light source	Version	Autonomy [h]	Weight [kg]
591 34 01 EM	10 / 300	3 x LED	M / NM	3	4,9
591 34 02 EM	17 / 937	10 x LED	M / NM	3	4,9

CE	Grounding symbol	LED	IP66	F	EMERGENCY
198 - 264V AC 176-276V DC 9-60V DC for 591 34 24 230V AC for „EM“			Ta -30°C ÷ +40°C +5°C ÷ +40°C „EM“ -25°C ÷ +45°C for 591 34 24		
Carton (mm/pcs) 415 x 235 x 210 / 1					

Type	Power input [W] / Luminous flux [lm]	Luminous efficiency [lm/W]	Angle of beam [°]	Colour temperature [K]	CRI	Weight [kg]
591 34 01	27 / 3426	126	120	4000	>80	6
591 34 02	19 / 2466	129	120	4000	>80	6
591 34 24	12 / 1446	120	120	4000	>80	6

TO ORDER



Protective sand-blasted glass
132.2551



Protective basket
1-99.8535/1



Cable gland plastic
M20x1,5



Cable gland metal
M20x1,5



Blinding plug
M20x1,5

TUB LED PRO

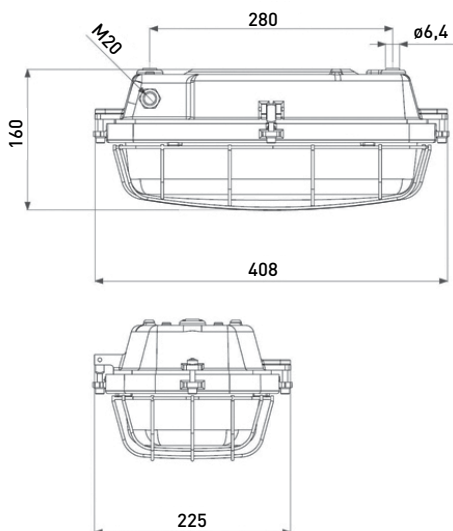

USE Light fitting for the illumination of indoor and outdoor industrial spaces.

TECHNICAL DESCRIPTION The light fitting body and flange are AlSi alloy castings finished with powder paint. There are two cable outlets on the sides of the light fitting. There is a LED module built inside the light fitting and it is comprised of a board fitted with LEDs and a power supply. The light fitting is designed as a through light fitting. When the light fitting is used as a terminal light fitting, the free cable outlet is blinded with a plug. The max. cross-section of the connecting conductors is 2.5 mm². The light fitting is produced with plastic cable glands as a standard, metal cable glands are available on request.

INSTALLATION On the ceiling, wall.

VERSIONS The light fittings are provided with a self-resetting thermal fuse and a surge guard up to 10 kV.

LIFETIME 100.000 hours, L90B10

FUNKCE DRIVERU eCLO, ITG, IVG+, Power-up fading

CONTROL DALI-2

CE	LED	IP66	F
198 – 264V AC 176-280V DC		Ta -40°C ÷ + 50°C	
Carton (mm/pcs) 415 x 235 x 210 / 1			

Type	Power input [W] / Luminous flux [lm]	Luminous efficiency [lm/W]	Angle of beam [°]	Colour temperature [K]	CRI	Weight [kg]
591 34 01 PRO	30 / 3572	129	120	4000	>80	6
591 34 02 PRO	20 / 2419	129	120	4000	>80	6

TO ORDER



Protective sand-blasted glass
132.2551



Protective basket
1-99.8535/1



Cable gland plastic
M20x1,5



Cable gland metal
M20x1,5



Blinding plug
M20x1,5



TURTLE LED

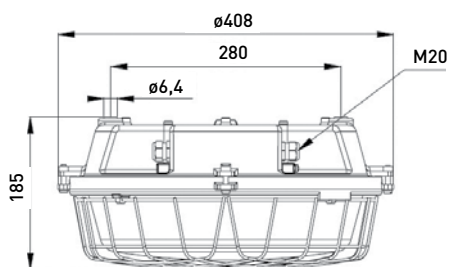

USE Light fitting for the illumination of indoor and outdoor industrial spaces.

TECHNICAL DESCRIPTION The light fitting body and flange are AlSi alloy castings finished with powder paint. There are two cable outlets on the sides of the light fitting. There is a LED module built inside the light fitting and it is comprised of a board fitted with LEDs and a power supply. The light fitting is designed as a through light fitting. When the light fitting is used as a terminal light fitting, the free cable outlet is blinded with a plug. The max. cross-section of the connecting conductors is 2.5 mm². The light fitting is produced with plastic cable gland as standard, metal gland is available on request.

INSTALLATION On the ceiling, wall or another solid substrate (structure) ensuring firm connection.

VERSIONS The light fittings are provided with a self-resetting thermal fuse and a surge guard up to 3 kV.

LIFETIME 50.000 hours, L80B20

CE		LED	198 - 264V AC 176-276V DC
IP66		Ta -30°C ÷ +40°C	
Carton (mm/pcs) 400 x 400 x 190 / 1			

Type	Power input [W] / Luminous flux [lm]	Luminous efficiency [lm/W]	Angle of beam [°]	Colour temperature [K]	CRI	Weight [kg]
591 35 01	50 / 6473	129	120	4000	>80	8
591 35 02	30 / 4039	135	120	4000	>80	8
591 35 03	20 / 2709	135	120	4000	>80	8

TO ORDER



Protective sand-blasted glass
232.5070



Protective basket
1-99.8534/1



Cable gland plastic
M20x1,5



Cable gland metal
M20x1,5



Blinding plug
M20x1,5

TURTLE LED PRO

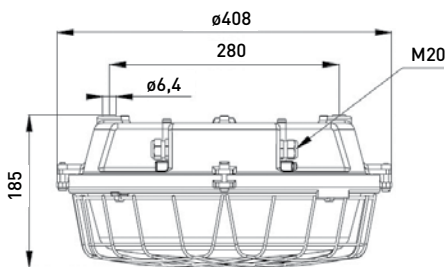
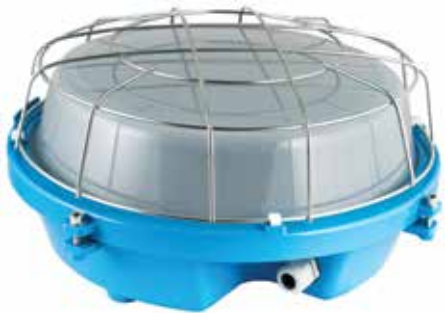

USE Light fitting for the illumination of indoor and outdoor industrial spaces.

TECHNICAL DESCRIPTION The light fitting body and flange are AlSi alloy castings finished with powder paint. There are two cable outlets on the sides of the light fitting. There is a LED module built inside the light fitting and it is comprised of a board fitted with LEDs and a power supply. The light fitting is designed as a through light fitting. When the light fitting is used as a terminal light fitting, the free cable outlet is blinded with a plug. The max. cross-section of the connecting conductors is 2.5 mm². The light fitting is produced with plastic cable gland as standard, metal gland is available on request.

INSTALLATION On the ceiling, wall or another solid substrate (structure) ensuring firm connection.

VERSIONS The light fittings are provided with a self-resetting thermal fuse and a surge guard up to 10 kV. The emergency version of the light fittings for permanent (M) and non-permanent (NM) emergency illumination with autonomy of 1 hour.

LIFETIME 100.000 hours, L90B10

FUNKCE DRIVERU eCLO, ITG, IVG+, Power-up fading

CONTROL DALI-2

Type	Power input [W] / Luminous flux [lm]	Version	Autonomy [h]	Weight [kg]
591 35 01 PRO EM	55 / 6473	M / NM	1	8
591 35 02 PRO EM	35 / 4039	M / NM	1	8
591 35 03 PRO EM	25 / 2709	M / NM	1	8

CE	⊕	LED	EMERGENCY	198 – 264V AC 176-280V DC
IP66	F	Ta 591 35 01 for: -40°C ÷ +50°C 591 35 02 for: -40°C ÷ +55°C 591 35 03 for: -40°C ÷ +60°C		
Carton (mm/pcs) 400 x 400 x 190 / 1				

Type	Power input [W] / Luminous flux [lm]	Luminous efficiency [lm/W]	Angle of beam [°]	Colour temperature [K]	CRI	Weight [kg]
591 35 01 PRO	50 / 6473	129	120	4000	>80	8
591 35 02 PRO	30 / 4039	135	120	4000	>80	8
591 35 03 PRO	20 / 2709	135	120	4000	>80	8

TO ORDER



Protective sand-blasted glass
232.5070



Protective basket
1-99.8534/1



Cable gland plastic
M20x1,5



Cable gland metal
M20x1,5



Blinding plug
M20x1,5



MULTIFREEZE LED



USE Light fitting for the illumination of indoor and outdoor industrial spaces.

TECHNICAL DESCRIPTION The light fitting body and flange are AlSi alloy castings finished with powder paint. There are two cable outlets M20 x 1,5 on the sides of the light fitting. There is a LED module built inside the light fitting and it is comprised of a board fitted with LEDs and a power supply. The light fitting is designed as a through light fitting. When the light fitting is used as a terminal light fitting, the free cable outlet is blinded with a plug. The light fitting is produced with plastic cable glands as a standard, metal cable glands are available on request

INSTALLATION On the ceiling, wall or another solid substrate (structure) ensuring firm connection.

VERSIONS Light fittings are made in versions for permanent (M) and non-permanent (NM) emergency illumination, with autonomy of 1 hours.

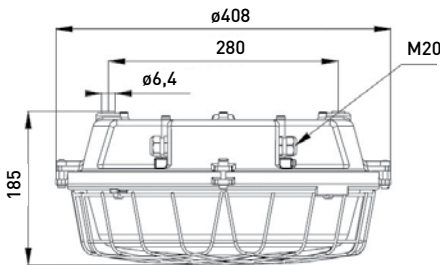

CE	LED	220 - 240V AC 190-245V DC
IP66	EMERGENCY	230V 50Hz
		Ta -30°C ÷ +50°C
Carton (mm/pcs) 400 x 400 x 190 / 1		

Type	Power input [W] /Luminous flux [lm]	Light source	Version	Autonomy [hr]	Weight [kg]
591 35 01 FEM	11 / 20	6 x LED	M/NM	1	8

TO ORDER



Transparent glass cover
232.5070



Protective basket
1-99.8534/1



Cable gland plastic
M20x1,5



Cable gland metal
M20x1,5



Blinding plug
M20x1,5

ŠACHO LED



USE Light fitting for the illumination railroad tracks and railway areas.

TECHNICAL DESCRIPTION The body is made of aluminium alloy. There is electrical equipment and rope holder of the bottom of the touch clutch. The body cover is made of steel sheet metal finished with powder paint. The reflector is made of aluminium sheet.

INSTALLATION By suspension.

LIFETIME 50 000 hours, L80B20

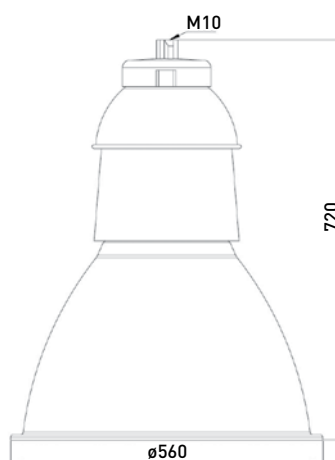

CE	⊕	LED	IP66 IP23	230V 50Hz
Ta -30°C ÷ + 50°C				
Carton (mm/pcs) 570 x 570 x 800 / 1				

Type	Power input [W] /Luminous flux [lm]	Angle of beam [°]	Colour temperature [K]	CRI	Weight [kg]
449 06 04 LED/ES	100 / 13 000	120	4500	>80	5,1
449 06 05 LED/ES	150 / 19 500	120	4500	>80	8,2
449 06 06 LED/ES	200 / 26 000	120	4500	>80	9,1

The light fitting can be produced with a protective glass.



PRACHO PLA LED



USE

Light fitting for the illumination of indoor and outdoor industrial spaces.

TECHNICAL DESCRIPTION

The light fitting body is made of glass-fibre-reinforced polyester (GRP). The diffuser is supplied as standard in UV stabilised polycarbonate (PC). The caps are made of stainless steel. The mounting brackets are made of powder-coated sheet steel. The luminaire is equipped with a reflector made of sheet steel. The luminaire is manufactured as a 3-phase through luminaire. When the luminaire is used as an end luminaire, the free cable gland is blinded with an Ex-plug. The maximum cross-section of the connecting wires is 2,5mm².

INSTALLATION

On ceiling or wall using two brackets.

DESIGN

Light fittings are supplied with M20x1.5 cable glands as standard. The luminaire can be manufactured with an emergency unit, designation 591 14 xx EM.

LIFETIME

120.000 hours, L80B20

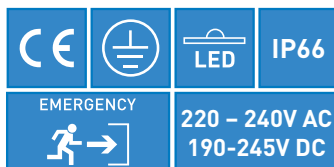

Type	Power input [W]	Luminous flux [lm]	Efficiency [lm / W]	Colour temperature [K]	CRI	Ambient temperature	Weight [kg]
591 14 01	71	12642	177	4000	>80	-35°C ÷ +50°C	6,5
591 14 02	61	10 272	166	4000	>80	-35°C ÷ +50°C	6,5
591 14 03	51	8 620	170	4000	>80	-35°C ÷ +50°C	6,5
591 14 04	45	7 944	177	4000	>80	-35°C ÷ +55°C	5,5
591 14 05	35	6 197	179	4000	>80	-35°C ÷ +55°C	5,5
591 14 06	25	4 435	166	4000	>80	-35°C ÷ +55°C	5,5
591 14 07	21	3 572	169	4000	>80	-35°C ÷ +60°C	3,5
591 14 08	14	2 414	168	4000	>80	-35°C ÷ +60°C	3,5

* EM - by adding the letters „EM“ the light fitting will be equipped with an emergency unit with autonomy up to 3 hours (e.g. 591 14 05EM)

PARAMETERS OF THE TYPE WITH EMERGENCY UNIT

Type	Power input [W]	Operating time [h]	Ambient temperature
591 14 xx EM	4,5	3	+5°C ÷ +50°C

DIMENSIONS

Type	L	L1	B	B1	H
591 14 01	1600	1000	190	160	129
591 14 02	1600	1000	190	160	129
591 14 03	1600	1000	190	160	129
591 14 04	1300	800	190	160	129
591 14 05	1300	800	190	160	129
591 14 06	1300	800	190	160	129
591 14 07	700	450	190	160	129
591 14 08	700	450	190	160	129

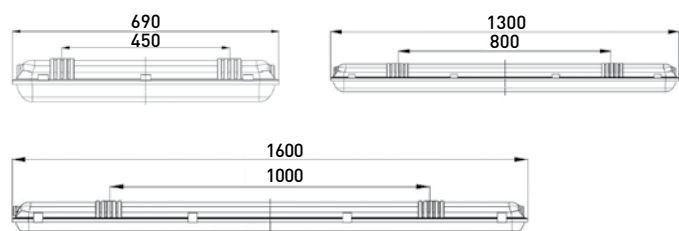

TO ORDER



SPARE PARTS

TO ORDER



Shade
254.5021/01

PEGAS LED
PEGAS LED PRO
JUNIOR LED
JUNIOR LED PRO



Shade
154.5041/2

TAURUS LED



Glass cover
232.5068/1

FARMER I LED
FARMER I LED PRO
FARMER II LED



Protective sand-blasted glass
232.5070

TURTLE LED
TURTLE LED PRO



Protective glass clear
31157

MULTIFREEZE LED



Protective sand-blasted glass
132.2551

TUB LED
TUB LED PRO



Protective basket
2-99.6325

PEGAS LED
PEGAS LED PRO



Protective basket
1-99.8534/1

TURTLE LED
TURTLE LED PRO
MULTIFREEZE LED



Protective steel basket
1-99.8535/1

TUB LED
TUB LED PRO



Protective basket
2-99.6325

TAURUS LED



Protective steel basket
1-99.6231

FARMER I LED
FARMER I LED PRO
FARMER II LED



Protective polycarbonate
basket 182.2540

FARMER I LED
FARMER I LED PRO
FARMER II LED



PMMA protective basket
182.5005

FARMER I LED
FARMER I LED PRO
FARMER II LED



PC diffuser
PRACHO PLA LED



Stainless steel cap
30543

PRACHO PLA LED



Holder for mounting
on the ceiling
4-99.7995



Holder for mounting
on the wall
338.2735



Blinding plug
M20x1,5 / M25x1,5



Stainless steel cap
4-99.6180

FARMER I LED
FARMER I LED PRO
FARMER II LED



Metal cap
4-99.8470

FARMER I LED
FARMER I LED PRO
FARMER II LED



Flexible suspension
2-99.5550



Cable gland plastic
M25x1,5 / M20x1,5



Cable gland metal
M25x1,5 / M20x1,5



CONTENT



JANUS I LED

38



JANUS II LED

40



INDUS LED

42

INDEX OF LIGHT FITTINGS

45

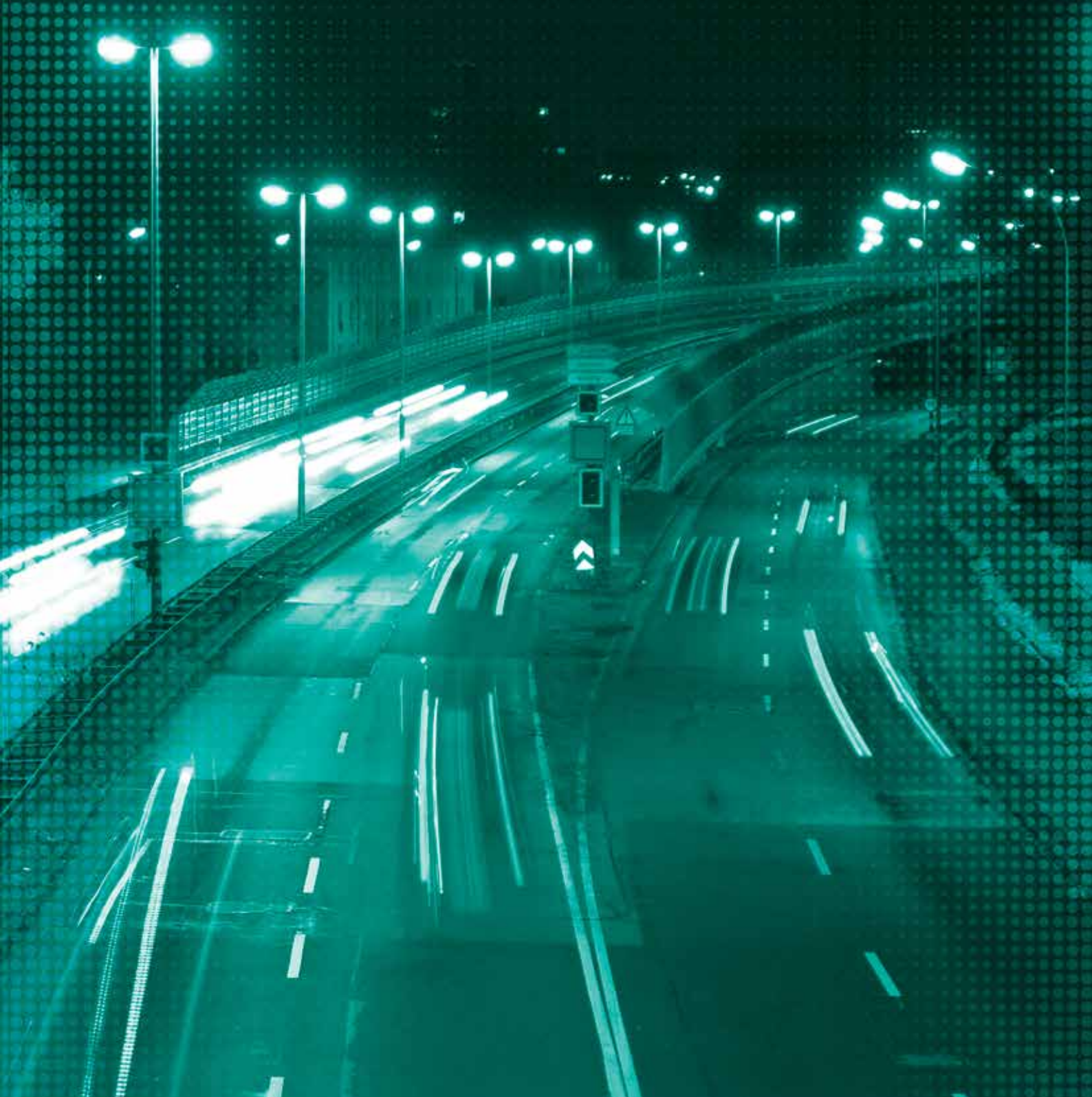

OUTDOOR LIGHTING

JANUS I LED



USE Light fitting for parking areas, roads and outdoor areas.

TECHNICAL DESCRIPTION The body of the lighting fitting is made of aluminium alloy, the diffuser is made of PC. The lighting fitting can be controlled by DALI, it is also equipped with surge protection up to 10kV.

LIFETIME 50.000 hours, L70B10

CONTROL DALI, 1-10V light sensor

CE	⏚	LED	50 - 60 Hz	IP66
100-240V AC 494 08 01,02,03				
200-240V AC 494 08 04, 05, 06, 07, 08				
Ta -30°C ÷ + 50°C		50 000 h L70B10		IK08

Type	Power input [W] /Luminous flux [lm]	Luminous efficiency [lm/W]	Colour temperature [K]	CRI	Weight [kg]	Dimensions d x š x v [mm]
494 08 01	20 / 2600	130	2700, 3000, 4000	>70	2	478 x 166 x 81
494 08 02	30 / 3750	125	2700, 3000, 4000	>70	2	478 x 166 x 81
494 08 03	50 / 6250	125	2700, 3000, 4000	>70	2,2	478 x 166 x 81
494 08 04	70 / 9000	128	2700, 3000, 4000	>70	3,1	507 x 203 x 88
494 08 05	90 / 12000	133	2700, 3000, 4000	>70	3,1	507 x 203 x 88
494 08 06	120 / 16000	133	2700, 3000, 4000	>70	4,0	570 x 256 x 88
494 08 07	150 / 20000	133	2700, 3000, 4000	>70	4,0	570 x 256 x 88

*Adding the designation e.g. WR1 (e.g. 494 08 04WR1) the light fitting will be produced with WIDEROAD optics.

JANUS I LED

Dimensions of 494 08 01, 02, 03

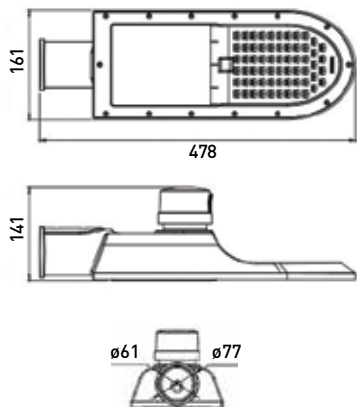

Dimensions of 494 08 04, 05

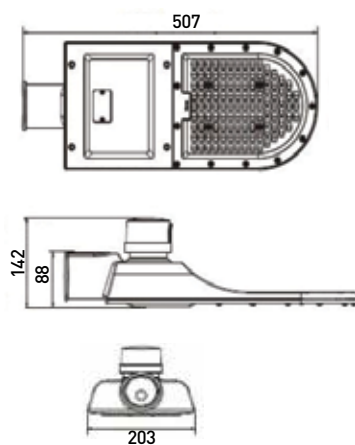

Dimensions of 494 08 06, 07

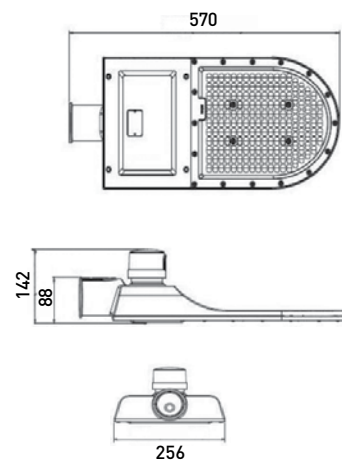

WR1

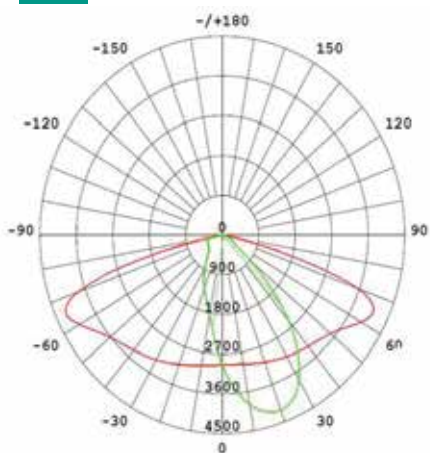

MR1

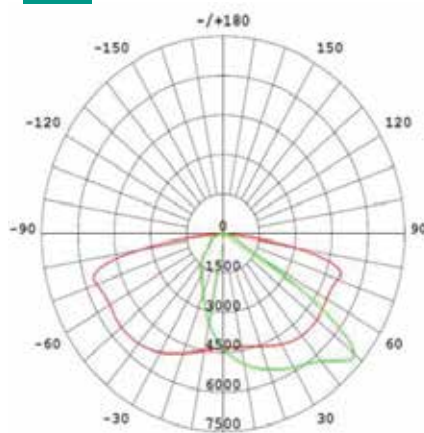

MR2

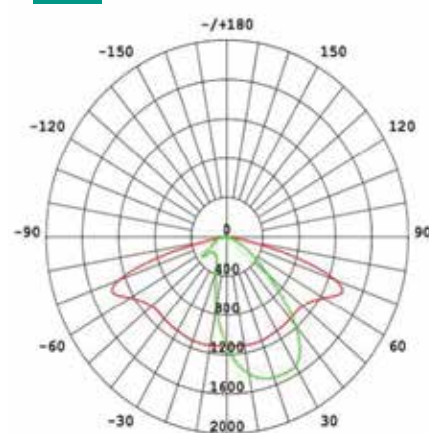

- WR1 Wide road for pavements, residential districts and access roads
- MR1 Main road main roads
- MR2 Main road main roads

JANUS II LED

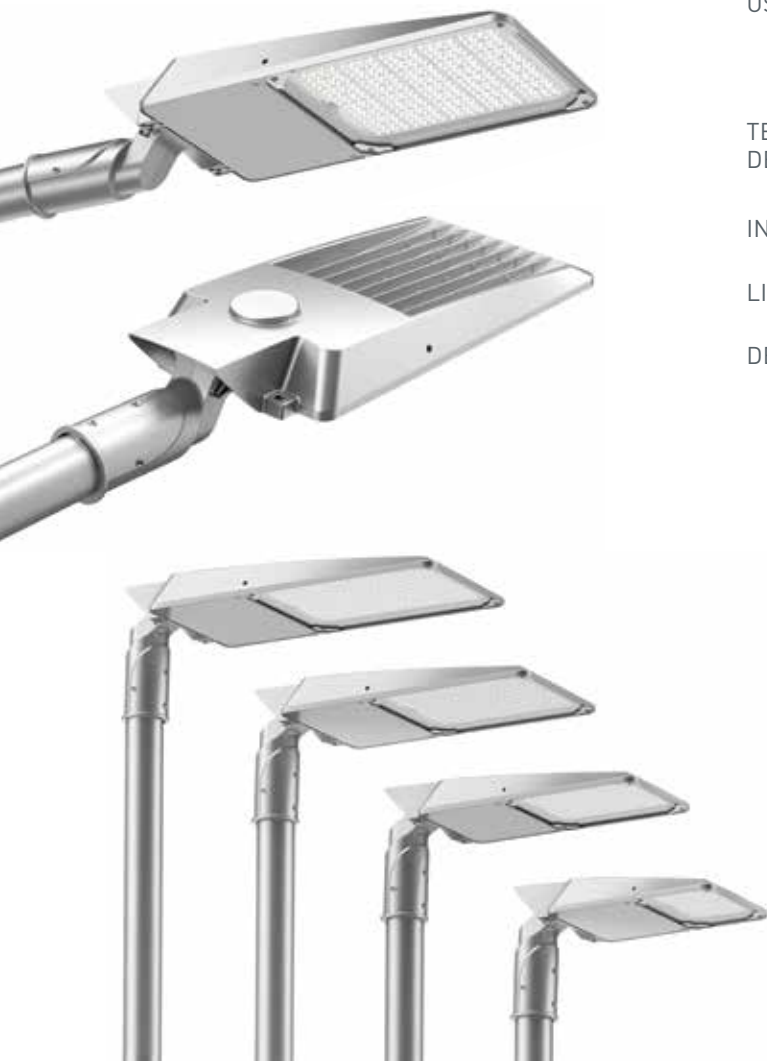

USE Light fitting to illuminate car parks, parks, streets and roads.

TECHNICAL DESCRIPTION The body of light fitting is made of aluminium, diffuser is made of tempered glass with PC optics.

INSTALLATION On pole, \varnothing 34, \varnothing 34-76

LIFETIME 80.000 hours, L80B20

DESIGN The light fitting can be produced in grey or black.

CE	LED	80 000 h L70B10
IP66	IK09	100 – 240V AC 50 – 60 Hz
Ta -30°C ÷ + 50°C		

Type	Power input [W] / Luminous flux [lm]	Luminous efficiency [lm/W]	Colour temperature [K]	CRI	Ø of the column shank [mm]	Weight [kg]	Dimensions d x š x v [mm]
494 09 01	20 / 3200	160	2700, 3000, 4000	>80	34	3,1	605 x 270 x 165
494 09 02	30 / 4800	160	2700, 3000, 4000	>80	34	3,1	605 x 270 x 165
494 09 03	40 / 6400	160	2700, 3000, 4000	>80	34	3,1	605 x 270 x 165
494 09 04	60 / 9600	160	2700, 3000, 4000	>80	42	5,9	710 x 270 x 165
494 09 05	75 / 12000	160	2700, 3000, 4000	>80	42	5,9	710 x 270 x 165
494 09 06	100 / 16000	160	2700, 3000, 4000	>80	42	5,9	710 x 270 x 165
494 09 07	120 / 19200	160	2700, 3000, 4000	>80	60	7,2	770 x 320 x 165
494 09 08	155 / 24800	160	2700, 3000, 4000	>80	60	7,2	770 x 320 x 165
494 09 09	185 / 29600	160	2700, 3000, 4000	>80	60	7,2	770 x 320 x 165
494 09 10	210 / 33600	160	2700, 3000, 4000	>80	76	8,5	840 x 335 x 165
494 09 11	240 / 38400	160	2700, 3000, 4000	>80	76	8,5	840 x 335 x 165

*Adding the designation e.g. WR3 [e.g. 494 09 03 WR3] the light fitting will be manufactured with WIDE ROAD optics.

JANUS II LED

CP

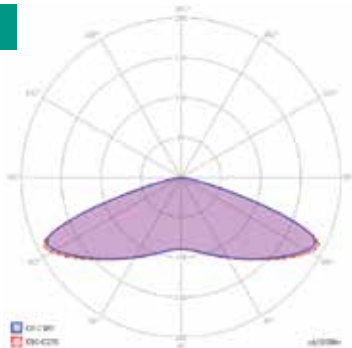

- CP Central parking for internal parts of parking areas
- MR1 Main road main road
- MR2 Main road main road
- WR1 Wide road for pavements and residential areas
- WR2 Wide road for sidewalks and driveways
- WR3 Wide road for pavements and access roads
- CW2 Crosswalk pedestrian crossings or cycleways
- NR Narrow road secondary roads
- WR4 Wide road for footpaths and driveways
- WR5 Wide road for footpaths and driveways

CW2

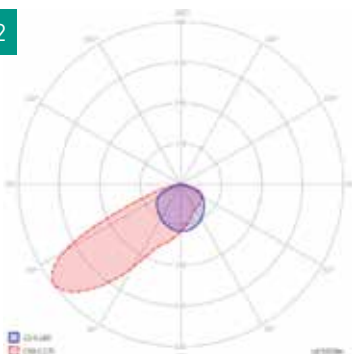

MR1

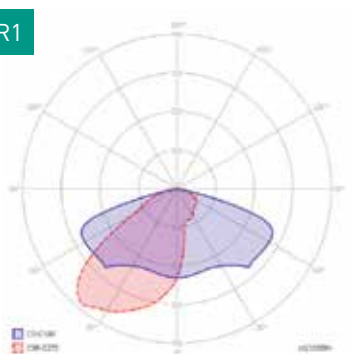

MR2

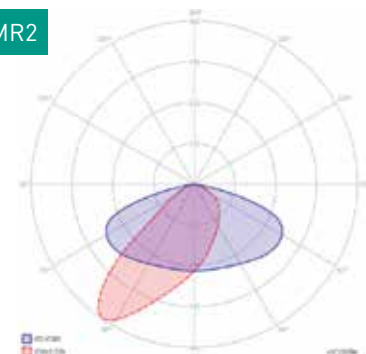

NR

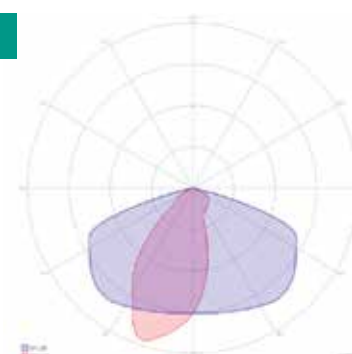

WR1

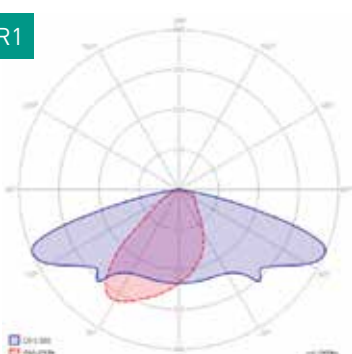

WR2

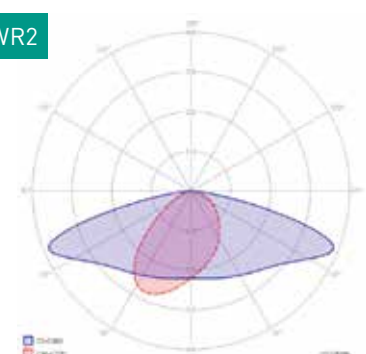

WR3

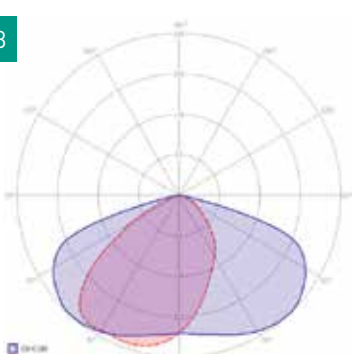

WR4

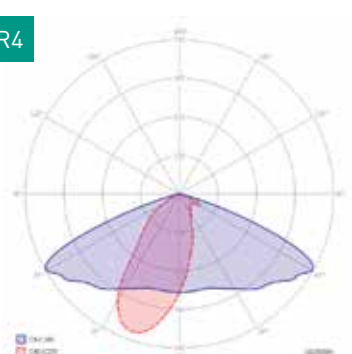

WR5

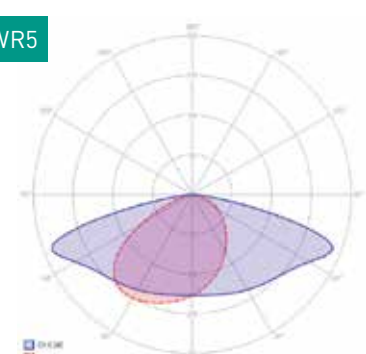

INDUS LED

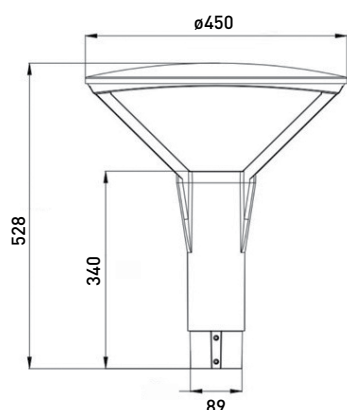

USE Light fitting for lighting park alleys, squares and open spaces. It can also be used to illuminate bicycle paths and parking lots.

TECHNICAL DESCRIPTION The body of the light fitting is made of aluminium, optics are polycarbonate lenses. The light fittings are available in grey or black. The light fitting is manufactured with surge protection up to 10kV.

LIFETIME 50.000 hours

CONTROL The light fitting can be produced with analogue control „AR“ or with digital DALI „DA“.

INSTALLATION On column, \varnothing 60 or \varnothing 76

			220 - 240V AC 50 - 60 Hz
IP66	IK08	DALI	Ta -30°C ÷ + 50°C

Type	Power input [W] / Luminous flux [lm]	Luminous efficiency [lm/W]	Colour temperature [K]	CRI	\varnothing of the column shank [mm]	Weight [kg]	Dimensions d x š x v [mm]
496 10 01	40 / 4800	120	2700, 3000, 4000, 5000	>70	60,76	7,05	450 x 450 x 526
496 10 02	60 / 7200	120	2700, 3000, 4000, 5000	>70	60,76	7,12	450 x 450 x 526
496 10 03	75 / 9000	120	2700, 3000, 4000, 5000	>70	60,76	7,22	450 x 450 x 526
496 10 04	100 / 12000	120	2700, 3000, 4000, 5000	>70	60,76	7,42	450 x 450 x 526

*Adding the designation „4K“ will result in the luminaire being manufactured with a chromaticity temperature of 4000K (e.g. 494 10 02 4K).

**Adding the designation „5K“ will result in a luminaire with a chromaticity temperature of 5000K (e.g. 494 10 05 5K).

***Adding the designation „DA“ after the type designation will result in luminaires manufactured with DALI control (e.g. 496 10 16 5K DA).

****Adding „AR“ to the type designation will result in the luminaire being manufactured with 1-10V analogue control (e.g. 494 10 08 4K AR).

*****By adding a designation e.g. „CW3“ after the type designation, the luminaire will be manufactured with a Crosswalk 3 beam curve. (e.g. 496 10 04 CW3).

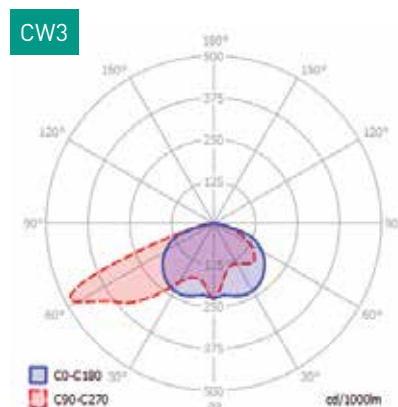
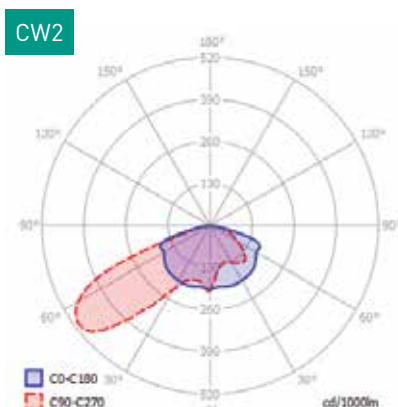
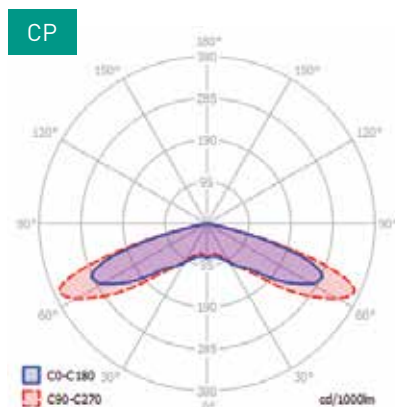

CP Central parking
CW2 Cross walk
CW3 Cross walk

inside parts of parking areas
pedestrian crossings or cycle paths
pedestrian crossings or cycle paths

NOTES



COMING SOON

RETRO DESIGN LUMINAIRES



Introducing our new design retro lighting range. Soon we will introduce you in detail the Elvis and Frank pendant lamps and the Charlie floor lamp. The luminaires of the retro design series also include the industrial luminaires MERIDIAN INDUSTRIAL and SIMPLEX INDUSTRIAL



ELVIS
suspension light fitting



FRANK
suspension light fitting



MERIDIAN INDUSTRIAL
industrial light fitting



SIMPLEX INDUSTRIAL
industrial light fittings



CHARLIE
floor lamp



Join us on social media



INDEX OF LIGHT FITTINGS

Type	Model	Purpose of application	Pg.
449 06 04LED/ES	ŠACHO LED	Industrial light fittings	33
449 06 05LED/ES	ŠACHO LED	Industrial light fittings	33
449 06 06LED/ES	ŠACHO LED	Industrial light fittings	33
494 08 01	JANUS I LED	Outdoor lighting	38
494 08 02	JANUS I LED	Outdoor lighting	38
494 08 03	JANUS I LED	Outdoor lighting	38
494 08 04	JANUS I LED	Outdoor lighting	38
494 08 05	JANUS I LED	Outdoor lighting	38
494 08 06	JANUS I LED	Outdoor lighting	38
494 08 07	JANUS I LED	Outdoor lighting	38
494 09 01	JANUS II LED	Outdoor lighting	40
494 09 02	JANUS II LED	Outdoor lighting	40
494 09 03	JANUS II LED	Outdoor lighting	40
494 09 04	JANUS II LED	Outdoor lighting	40
494 09 05	JANUS II LED	Outdoor lighting	40
494 09 06	JANUS II LED	Outdoor lighting	40
494 09 07	JANUS II LED	Outdoor lighting	40
494 09 08	JANUS II LED	Outdoor lighting	40
494 09 09	JANUS II LED	Outdoor lighting	40
494 09 10	JANUS II LED	Outdoor lighting	40
494 09 11	JANUS II LED	Outdoor lighting	40
496 10 01	INDUS LED	Outdoor lighting	42
496 10 02	INDUS LED	Outdoor lighting	42
496 10 03	INDUS LED	Outdoor lighting	42
496 10 04	INDUS LED	Outdoor lighting	42
511 37 01	MINEX I	Explosion-proof light fittings for mines	14
541 33 02	MINEX I	Explosion-proof light fittings for mines	14
591 13 01	LINEX PLA LED	Explosion-proof light fittings	12
591 13 02	LINEX PLA LED	Explosion-proof light fittings	12
591 13 03	LINEX PLA LED	Explosion-proof light fittings	12
591 13 04	LINEX PLA LED	Explosion-proof light fittings	12
591 13 05	LINEX PLA LED	Explosion-proof light fittings	12
591 13 06	LINEX PLA LED	Explosion-proof light fittings	12
591 13 07	LINEX PLA LED	Explosion-proof light fittings	12
591 13 08	LINEX PLA LED	Explosion-proof light fittings	12
591 15 01	JUNIOR LED	Industrial light fittings	20
591 15 01 PRO	JUNIOR LED PRO	Industrial light fittings	21
591 15 01n	ERIS LED	Explosion-proof light fittings	8



INDEX OF ALL TYPES OF LIGHT FITTINGS PRESENTED IN THE CATALOGUE

Type	Model	Purpose of application	Pg.
591 15 02	JUNIOR LED	Industrial light fittings	20
591 15 02 PRO	JUNIOR LED PRO	Industrial light fittings	21
591 15 02n	ERIS LED	Explosion-proof light fittings	8
591 15 03	JUNIOR LED	Industrial light fittings	20
591 15 03 PRO	JUNIOR LED PRO	Industrial light fittings	21
591 15 03n	ERIS LED	Explosion-proof light fittings	8
591 32 01n	BILUX LED	Explosion-proof light fittings	9
591 32 01nEM	MULTISAFE LED	Explosion-proof light fittings	11
591 32 02n	BILUX LED	Explosion-proof light fittings	9
591 32 02nEM	MULTISAFE LED	Explosion-proof light fittings	11
591 33 01n	TRILUX LED	Explosion-proof light fittings	10
591 33 02n	TRILUX LED	Explosion-proof light fittings	10
591 33 03n	TRILUX LED	Explosion-proof light fittings	10
591 34 01	TUB LED	Industrial light fittings	28
591 34 01 EM	TUB LED	Industrial light fittings	28
591 34 01 PRO	TUB LED PRO	Industrial light fittings	29
591 34 02	TUB LED	Industrial light fittings	28
591 34 02 EM	TUB LED	Industrial light fittings	28
591 34 02 PRO	TUB LED PRO	Industrial light fittings	29
591 34 24	TUB LED	Industrial light fittings	28
591 35 01	TURTLE LED	Industrial light fittings	30
591 35 01 PRO	TURTLE LED PRO	Industrial light fittings	31
591 35 01 PRO EM	TURTLE LED PRO	Industrial light fittings	31
591 35 01FEM	MULTIFREEZE LED	Industrial light fittings	32
591 35 02	TURTLE LED	Industrial light fittings	30
591 35 02 PRO	TURTLE LED PRO	Industrial light fittings	31
591 35 02 PRO EM	TURTLE LED PRO	Industrial light fittings	31
591 35 03	TURTLE LED	Industrial light fittings	30
591 35 03 PRO	TURTLE LED PRO	Industrial light fittings	31
591 35 03 PRO EM	TURTLE LED PRO	Industrial light fittings	31
591 36 01	FARMER I LED	Industrial light fittings	22
591 36 01 PRO	FARMER I LED PRO	Industrial light fittings	24
591 36 02	FARMER I LED	Industrial light fittings	22
591 36 02 PRO	FARMER I LED PRO	Industrial light fittings	24
591 37 01	FARMER II LED	Industrial light fittings	26
591 39 04	ORION LED	Explosion-proof light fittings	6
591 39 05	ORION LED	Explosion-proof light fittings	6
591 40 01	MINIMINEX LED	Explosion-proof light fittings for mines	13

INDEX OF ALL TYPES OF LIGHT FITTINGS PRESENTED IN THE CATALOGUE

Type	Model	Purpose of application	Pg.
591 41 01	PEGAS LED	Industrial light fittings	18
591 41 01 PRO	PEGAS LED PRO	Industrial light fittings	19
591 41 02	PEGAS LED	Industrial light fittings	18
591 41 02 PRO	PEGAS LED PRO	Industrial light fittings	19
591 44 01	SIRIUS LED	Explosion-proof light fittings	7
591 44 02	SIRIUS LED	Explosion-proof light fittings	7
591 44 03	SIRIUS LED	Explosion-proof light fittings	7
591 46 01	TAURUS LED	Industrial light fittings	27
591 46 02	TAURUS LED	Industrial light fittings	27
591 46 03	TAURUS LED	Industrial light fittings	27
592 36 03	FARMER I LED	Industrial light fittings	22
592 36 03 PRO	FARMER I LED PRO	Industrial light fittings	24
592 37 03	FARMER II LED	Industrial light fittings	26
593 36 04	FARMER I LED	Industrial light fittings	22
593 36 04 PRO	FARMER I LED PRO	Industrial light fittings	24
593 37 04	FARMER II LED	Industrial light fittings	26



WWW.ELEKTROSVIT.CZ

