

ES EXL450LED

Use:

Designed to be used in the zones 21&2,22 of the explosion hazard of gases, vapors and mists of flammable liquids with air, as well as of flammable dusts and fibers.

Zone 21
Zone 2/22



II 3G Ex ec IIC T6... T4 Gc
II 2D Ex tb IIIC T80°C...T105°C Db

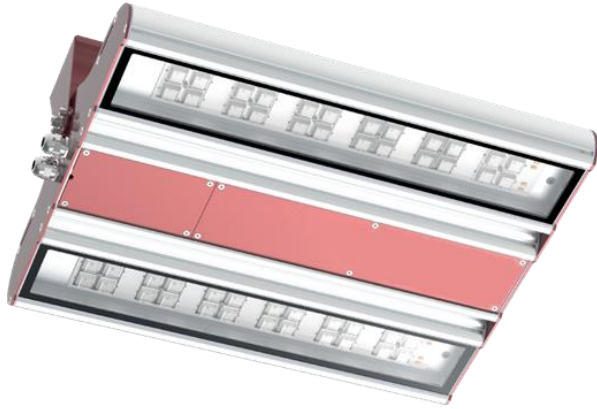

CE	IK10 - PC IK09 - GL	IP66 IP67	ATEX
LED	4000K 6500K (optionally)	CRI: >70 CRI: >80 (optionally)	Ta -40°C ÷ +65°C
Input voltage:		24E: 230-277 V, 50-60 Hz	25E: 230-305 V, 50-60 Hz



Technical description:

The housing is made of anodized aluminum. The diffuser can be made of glass or polycarbonate. There is a possibility to choose one out of four available optics. Versions compatible ZB and DA with DALI protocol can be chosen optionally. Additional accessories as protection grid PGR or vent plugs VENT can be installed optionally.

Installation:

Ceiling or wall mounted with bracket

Version:

The luminaire is supplied as standard with polyamide gland M20x1,5, on request also polyamide gland M25x1,5.

Lifetime:

>50.000h L₈₀B₁₀

>70.000h L₇₀B₁₀

To order:

DALI driver interface, PGR protective grid, VENT ventilation plugs

Type	Power input [W]	Luminous efficiency [lm/W]	Luminous flux [lm]*	Ambient temperature [°C]	Temperature class / max. temperature of class
ES EXL450LED-EX2-1	101	155	16000	-40°C ÷ + 60 (25E) / +65 (24E)	T6 / T80°C
ES EXL450LED-EX2-2	149	153	23000	-40°C ÷ + 55 (25E) / +60 (24E)	T5 / T80°C
ES EXL450LED-EX3-1	153	157	24000	-40°C ÷ + 60 (25E) / +65 (24E)	T5 / T80°C
ES EXL450LED-EX3-2	236	144	34000	-40°C ÷ + 45 (25E) / +50 (24E)	T4 / T105°C
ES EXL450LED-EX4-1	199	157	31500	-40°C ÷ + 50 (25E) / +55 (24E)	T5 / T80°C

* Luminous flux is indicated for LED modules CRI 70.

The luminous flux for the version ZB is 30% lower than nominal.

Luminous flux tolerance +/- 10%.

The parameters given in the following data sheet has been determined for the temperature Ta=25°C

Photometry:

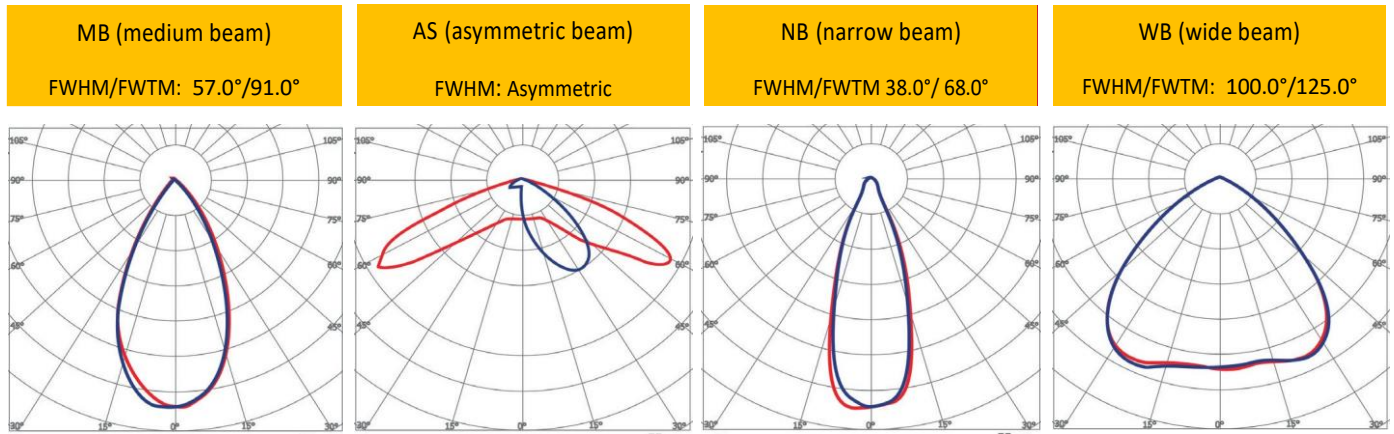

Dimension:

Version EX2

Standard mounting AMO90

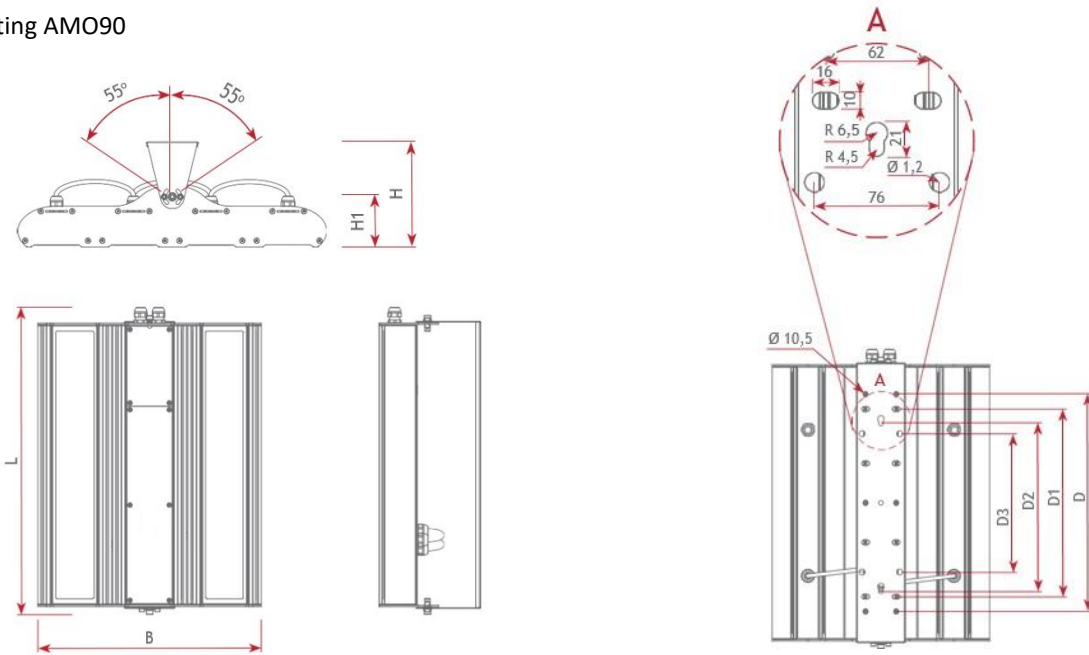

Version EX3

Standard mounting AMO90

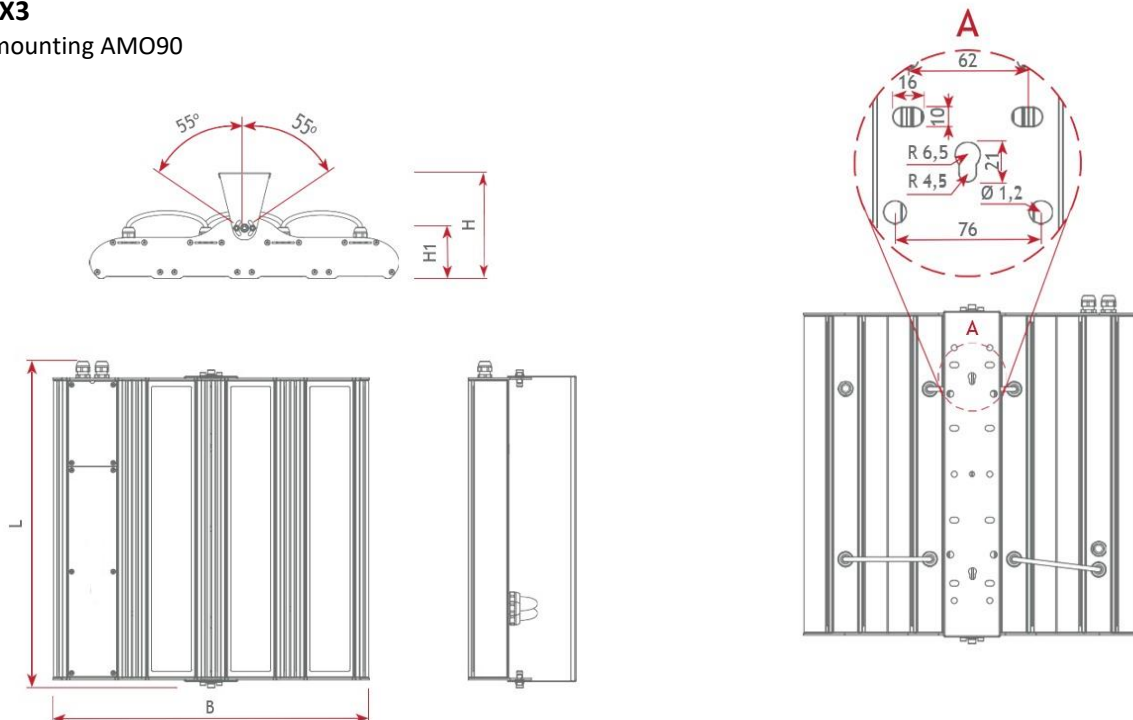

Version EX4

Standard mounting AMO90

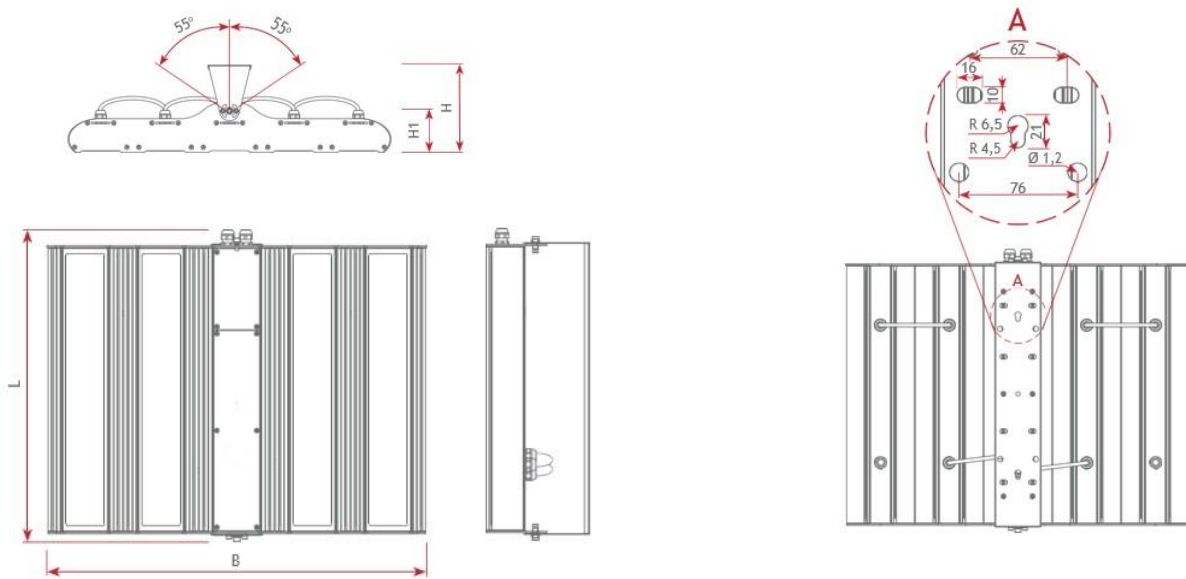

Dimension comparison

Type	L	B	H	H1	D	D1	D2	D3	Weight [kg]
ES EXL450LED-EX2	606	435	202	97	440	380	340	280	10
ES EXL450LED-EX3	606	585	202	97	440	380	340	280	13
ES EXL450LED-EX4	606	735	202	97	440	380	340	280	16

Maximal quantity of fittings that may be connected according to the used circuit breaker:

Version 25E

Version 24E

Type	PSU B16	PSU C16
ES EXL450LED-EX2-1	3	6
ES EXL450LED-EX2-2	3	6
ES EXL450LED-EX3-1	3	6
ES EXL450LED-EX3-2	2	4
ES EXL450LED-EX4-1	2	4

Type	PSU B16	PSU C16
ES EXL450LED-EX2-1	7	11
ES EXL450LED-EX2-2	6	6
ES EXL450LED-EX3-1	6	6
ES EXL450LED-EX3-2	7	4
ES EXL450LED-EX4-1	3	3

Mountings:

AMO90
standard

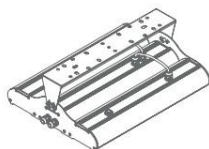
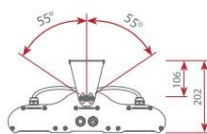

AMO360
optional

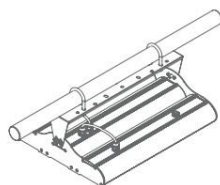

AMO180
optional

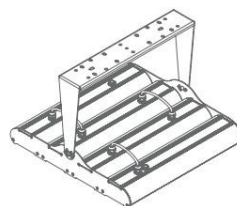
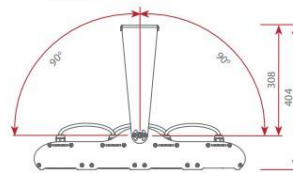

Configurations:

ES ESL450LED – EX ¹ ² ³ ⁴ ⁵ ⁶ ⁷ **-ALU-** ⁸ ⁹ ¹⁰ ¹¹ ¹²

¹LED module quantity: 1, 2, 3 or 4

²Driving current: 1 or 2

³Power supply: 24E - 230-277V, 50-60Hz
25E - 230-305V, 50-60Hz or 230 – 431V, 0Hz

⁴Wiring: 30 - single 3-pole terminal
50 - single 5-pole terminal
70 - single 7-pole terminal

⁵Cable inlets - quantity: 10 – one cable inlet on the side of the housing
20 – two cable inlets on the side of the housing

⁶Cable inlets - material: M - metal
P - plastic

⁷Cable inlets – size: 20 - ø20
25 - ø25

⁸Diffuser material: GL – hardened glass
PL - UV stabilised polycarbonate

⁹Optics: NB - narrow beam
MB – medium beam
WB - wide beam
ASY – asymmetric beam

¹⁰Mountings

¹¹Additional options:

DA – version equipped with integrated power supply unit with DALI interface. Available only with 25E power supply version
3F – version adapted to work in a three-phase network, equipped with connectors 5x2,3 mm² (L1, L2, L3, PE, N)
ZB – version designed to work with a central battery. Available only with 25E power supply version

¹²Addition accessories:

PGR – version equipped with protection grid on the diffuser
VENT – version equipped with explosion-proof ventilated plugs (recommended in external use of the fitting)